

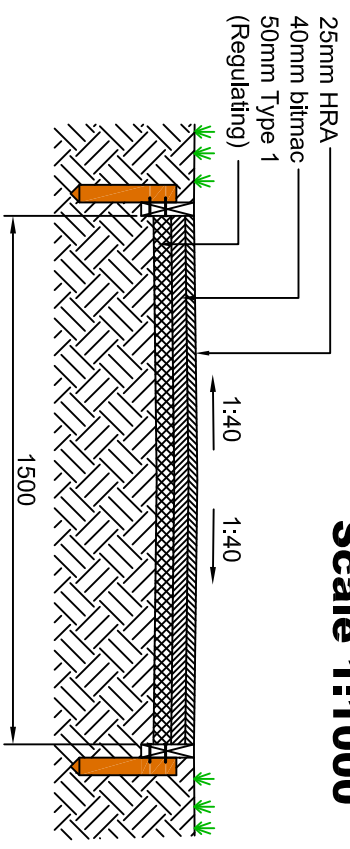

**Joppa Quarry Park
New Footpath Location
Scale 1:1000**

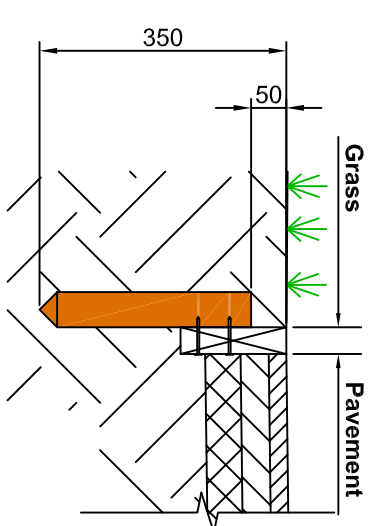

**Typical Section
Pavement Construction
Scale 1:20**



**Typical Edging Detail
Timber Edging Board
(150mmx38mm)
Scale 1:10**

TIMBER EDGING BOARD
150x38mm treated softwood board nailed to 50x50x300mm long softwood pegs with 2No. galvanised nails 50mm long. Preservative treatment to provide 15year service life. Pegs to be driven into ground @1200mm centres.

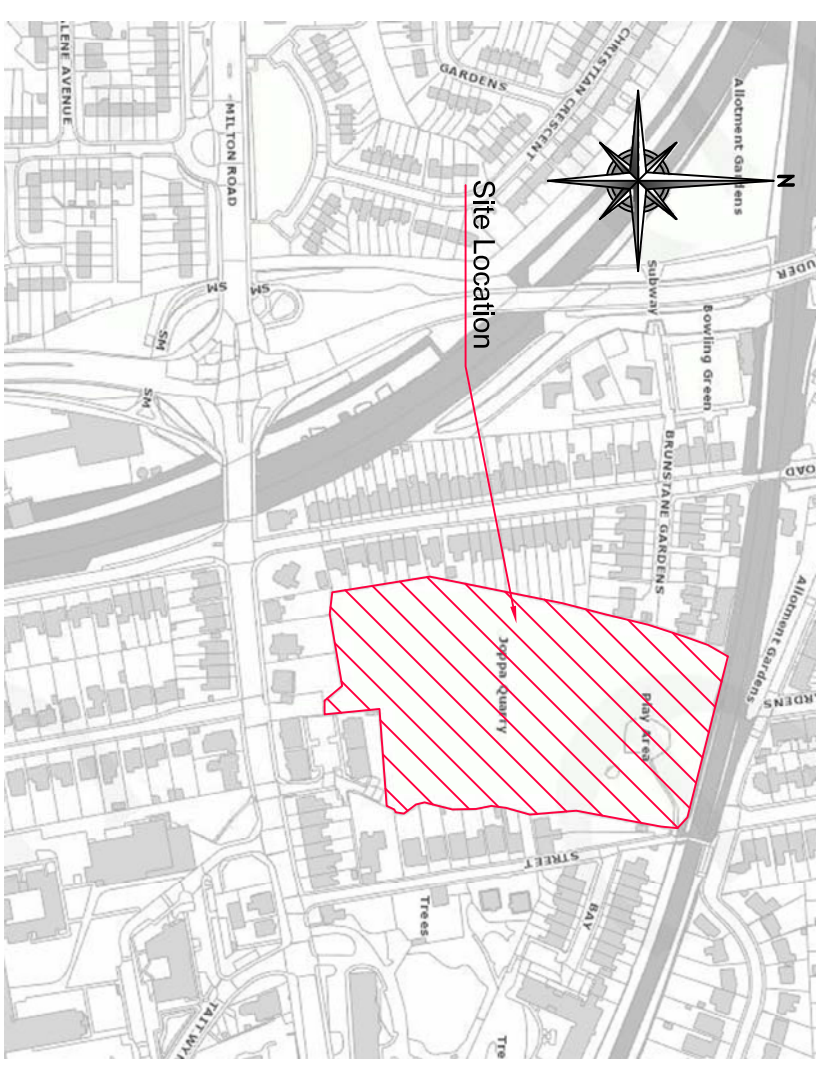

**Joppa Quarry Park
New Footpath
Location Plan (n.t.s.)**

Description Of Works

To construct new footpath as per details below in Joppa Quarry Park.

- Option 1 = 80 metres**
- Option 2 = 176 metres**
- Option 3 = 380 metres**

<p>EDINBURGH THE CITY OF EDINBURGH COUNCIL</p>	<p>North East Locality Transportation Team</p>
<p>The City of Edinburgh Council Place, North East Locality 101 Middlele Mains Road, Edinburgh EH16 4ZG Tel: No. 0131 - 529 - 3111</p>	
<p>Joppa Quarry Park New Footpath Sheet 1 : General</p>	
<p>DRG. No. W177/Park 01/June 2019</p>	<p>Date: June 2019 Scale: As Shown</p>
<p>Job. No.</p>	<p>Drawn by: KDA Checked by:</p>
<p>REVISION</p>	<p>BY DATE CHECKED</p>
<p>DETAILS</p>	<p>BY DATE CHECKED</p>