

NOTES

EXTEND PERMIT
HOLDERS PARKING
PLACE

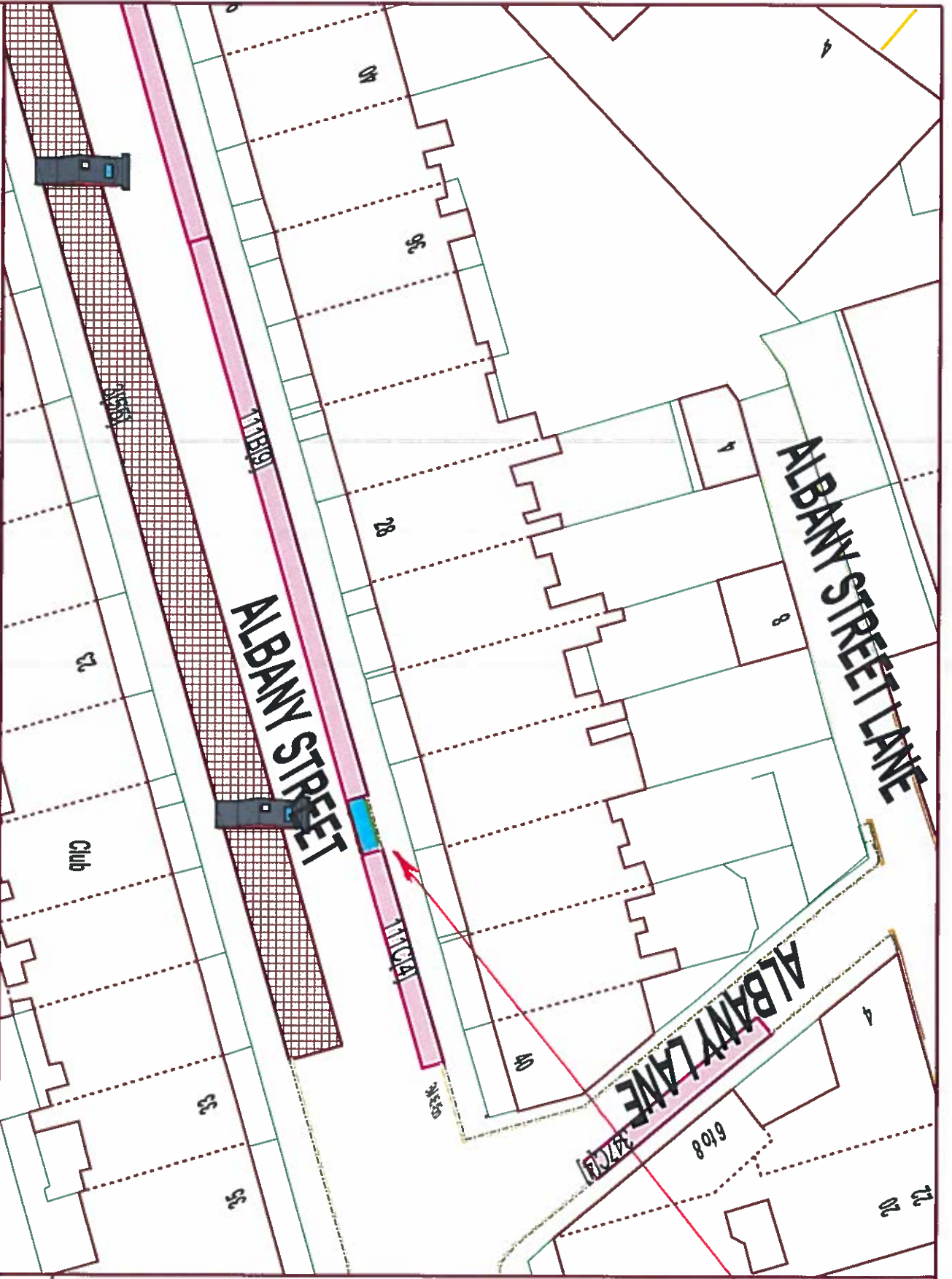

EDINBURGH

THE CITY OF EDINBURGH COUNCIL
Services for Communities,
4 East Market Street, Edinburgh EH1 1JN
Tel: 0131 280 2000

WAITING RESTRICTIONS
ALBANY STREET

1:500



The material contained in this plot has been reproduced from all Ordnance Survey maps with the permission of the Controller of Her Majesty's Stationery Office.



Produced using Southworld GIS

Date: 08/10/2014
Drawn By:
Dwg No:

NOTES

REDEFINE POSITION
OF SHARED USE
PARKING PLACE

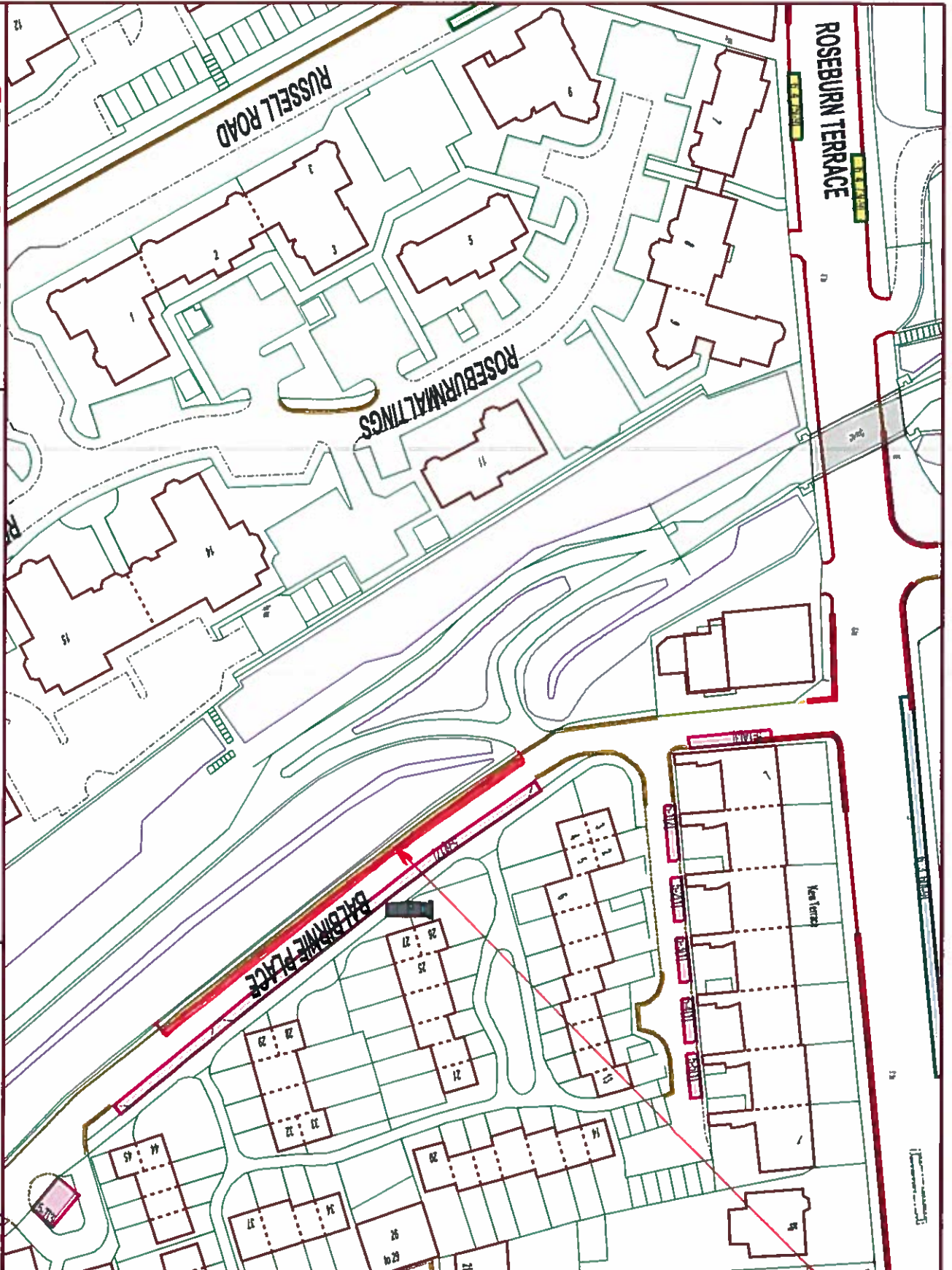

EDINBURGH

THE CITY OF EDINBURGH COUNCIL

Services for Communities,
4 East Market Street, Edinburgh EH8 8DN
Tel: 0131 200 2000

WAITING RESTRICTIONS

BALBIRNIE PLACE

1:1000



The material contained in this plan has been reproduced from an Ordnance Survey map with the permission of the Controller of HMSO. Crown Copyright.



Produced using Smartworld GIS

Date: 13/11/2014

Drawn By:

Dwg No.:

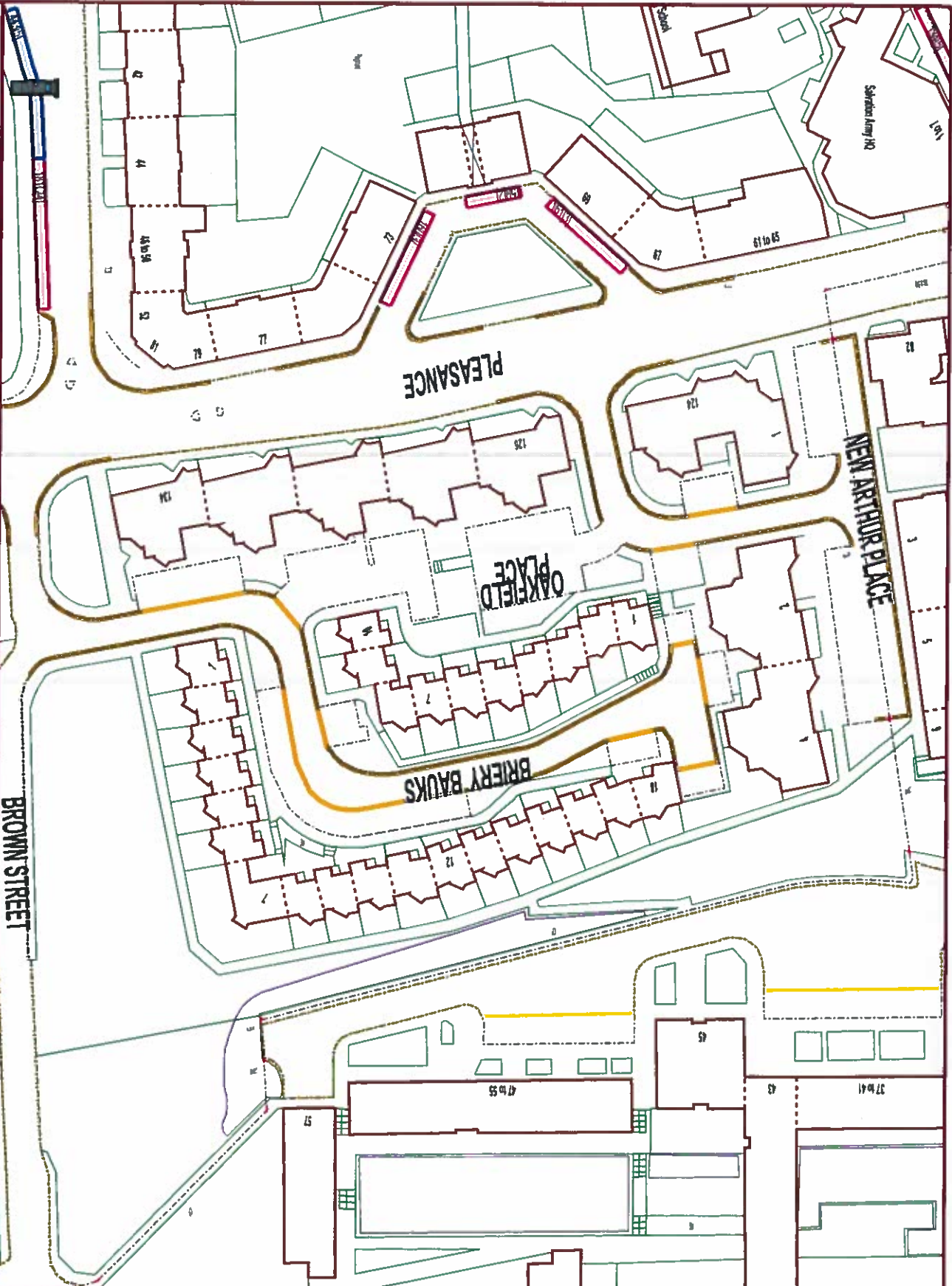

NOTES

NO RESIDENT PARKING PERMITS
TO BE ISSUED TO RESIDENCES ON
NEW ARTHUR PLACE
OAKFIELD PLACE
BRIERY BAUKS

Produced using Smallworld GIS

Date: 11/11/2014

Drawn By:

Dwg No.:

1:1000



The material contained in this plot has been reproduced from an Ordnance Survey map with the permission of the Controller of HMSO. Crown Copyright.

**WAITING RESTRICTIONS
NEW ARTHUR PL - BRIERY BAUKS AREA**

EDINBURGH

THE CITY OF EDINBURGH COUNCIL
Services for Communities,
4 East Market Street, Edinburgh EH8 8DZ
Tel: 0131 280 2000

NOTES

AMEND MAXIMUM DURATION OF STAY TO 2 HOURS

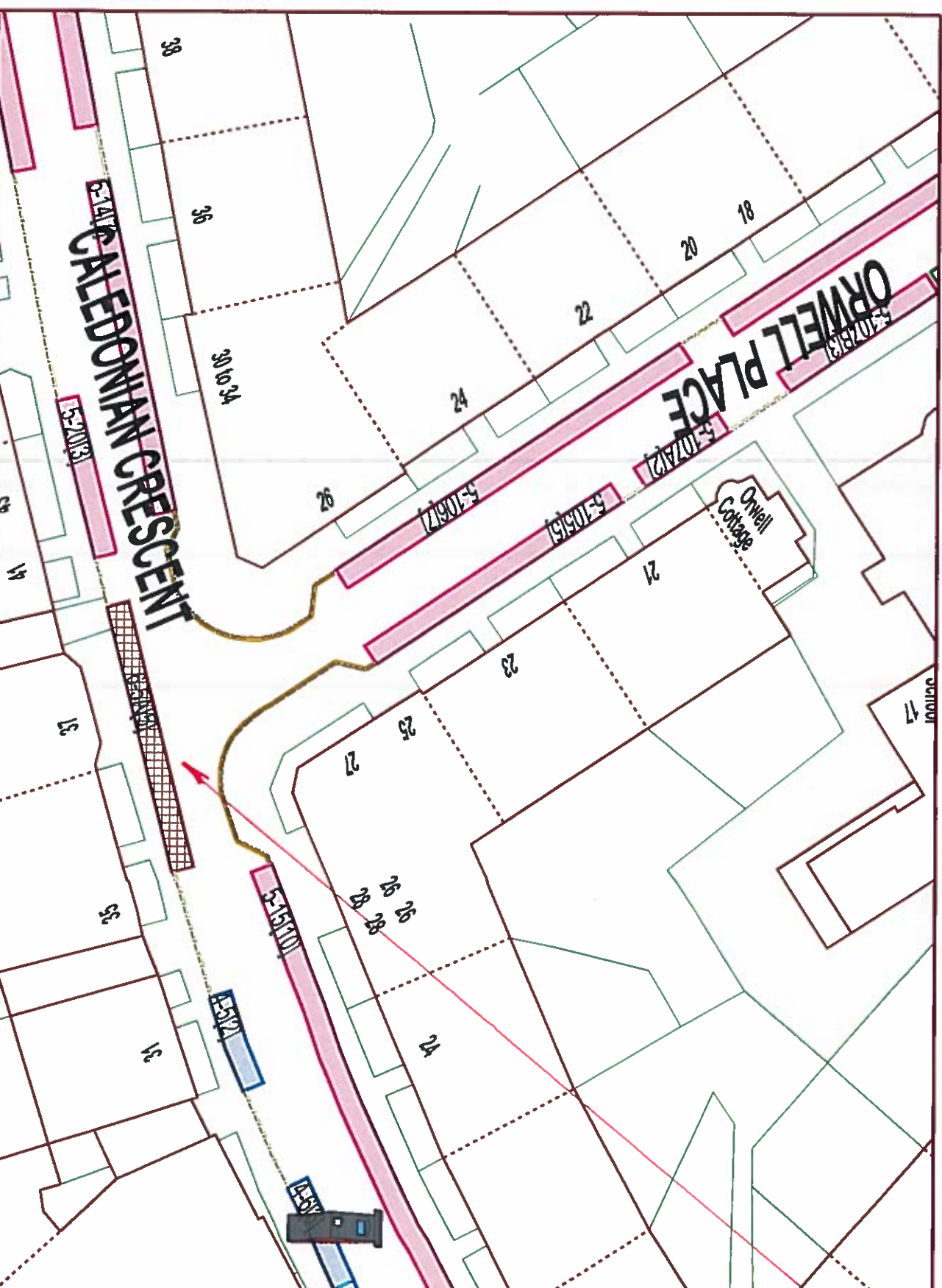

Produced using Smartworld GIS

Date: 11/11/2014
 Drawn By:
 Dwg No.:

1:500



The material contained in this plan has been reproduced from an Ordnance Survey map with the permission of the Controller of HMSO. Crown Copyright.

WAITING RESTRICTIONS
CALEDONIAN CRESCENT

EDINBURGH
 THE CITY OF EDINBURGH COUNCIL
 Services for Communities,
 4 East Market Street, Edinburgh EH8 8JH
 Tel: 0131 200 2000

NOTES

NO RESIDENT PARKING PERMITS
TO BE ISSUED TO NEW DEVELOPMENT
AT 6A CANNING STREET LANE

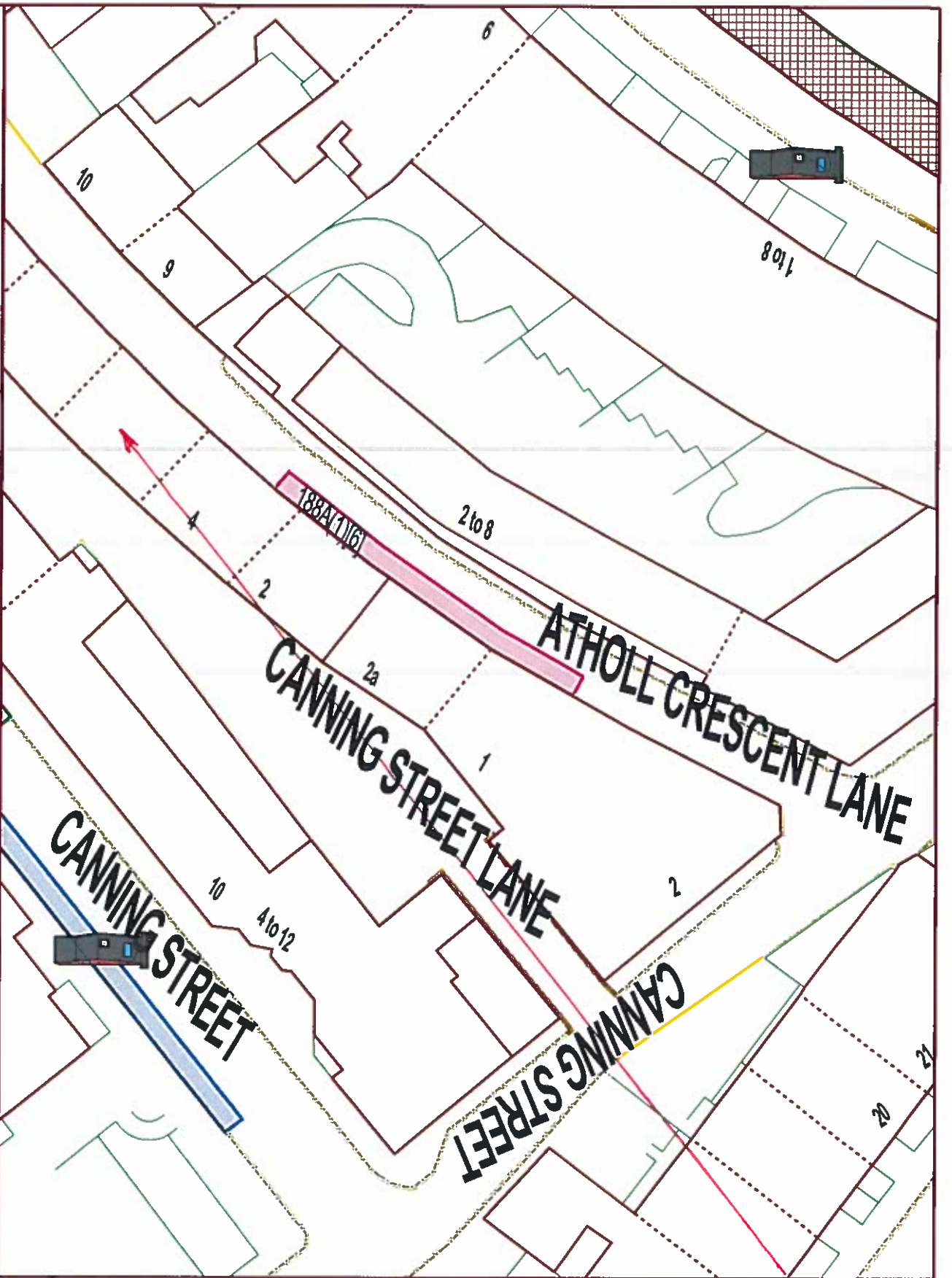

Produced using Smartworld CS

Date: 11/11/2014

Drawn By:

Dwg No:

1:500

The content covered in this plan has been reproduced from an Ordnance Survey map with the permission of the Controller of Her Majesty's Stationery Office.

WAITING RESTRICTIONS
CANNING STREET LANE

EDINBURGH
THE CITY OF EDINBURGH COUNCIL
Services for Communities,
4 East Market Street, Edinburgh EH9 1DN
Tel: 0131 200 2000

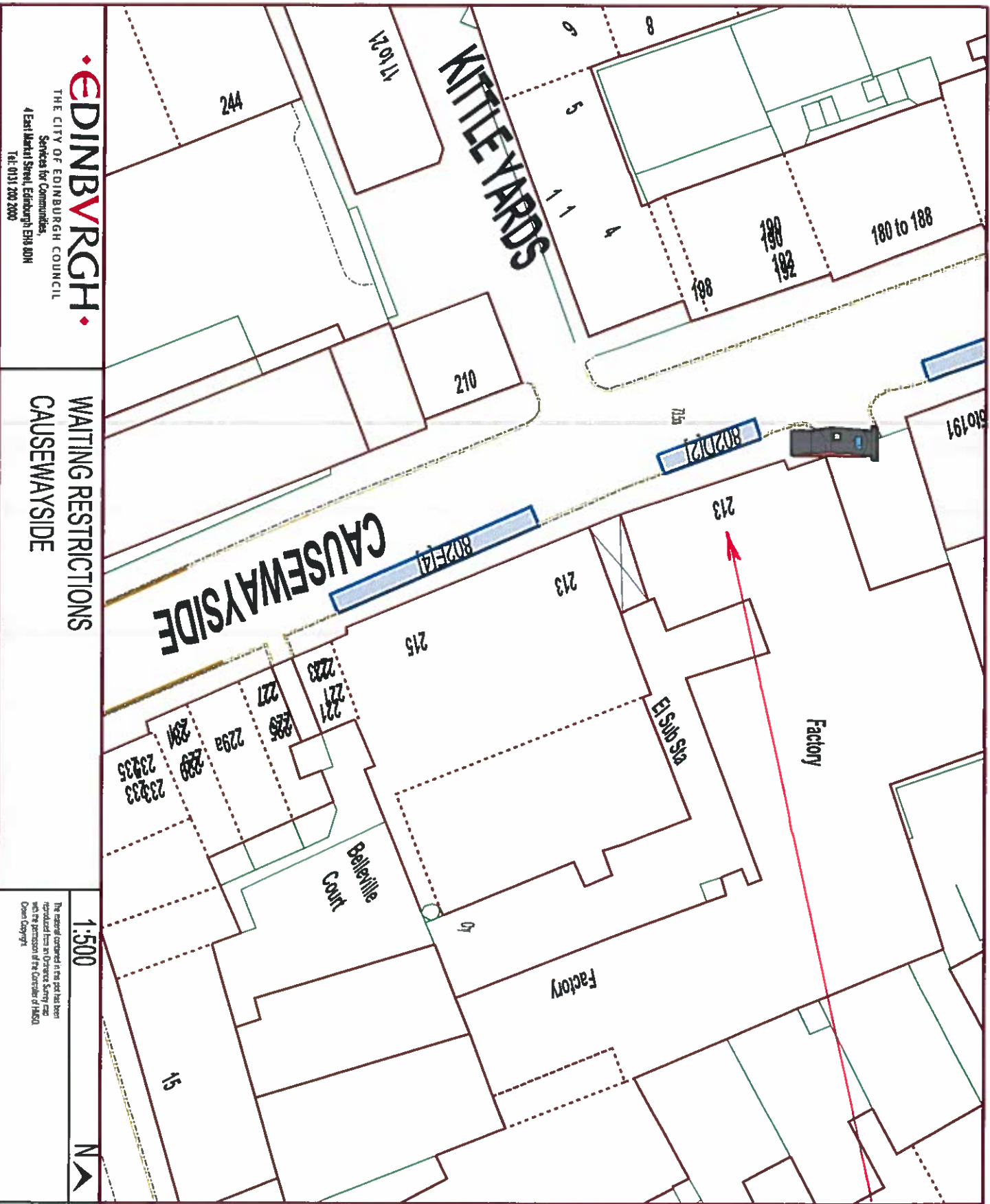

EDINBURGH
 THE CITY OF EDINBURGH COUNCIL
 Services for Communities
 4 East Market Street, Edinburgh EH9 6DN
 Tel: 0131 200 2000

**WAITING RESTRICTIONS
 CAUSEWAYSIDE**

1-500
 N

Produced using Scanworks CS
 Date: 11/11/2014
 Drawn By:
 Dwg No:

NOTES
 NO RESIDENT PARKING PERMITS
 TO BE ISSUED TO NEW DEVELOPMENT
 AT 195-213 CAUSEWAYSIDE

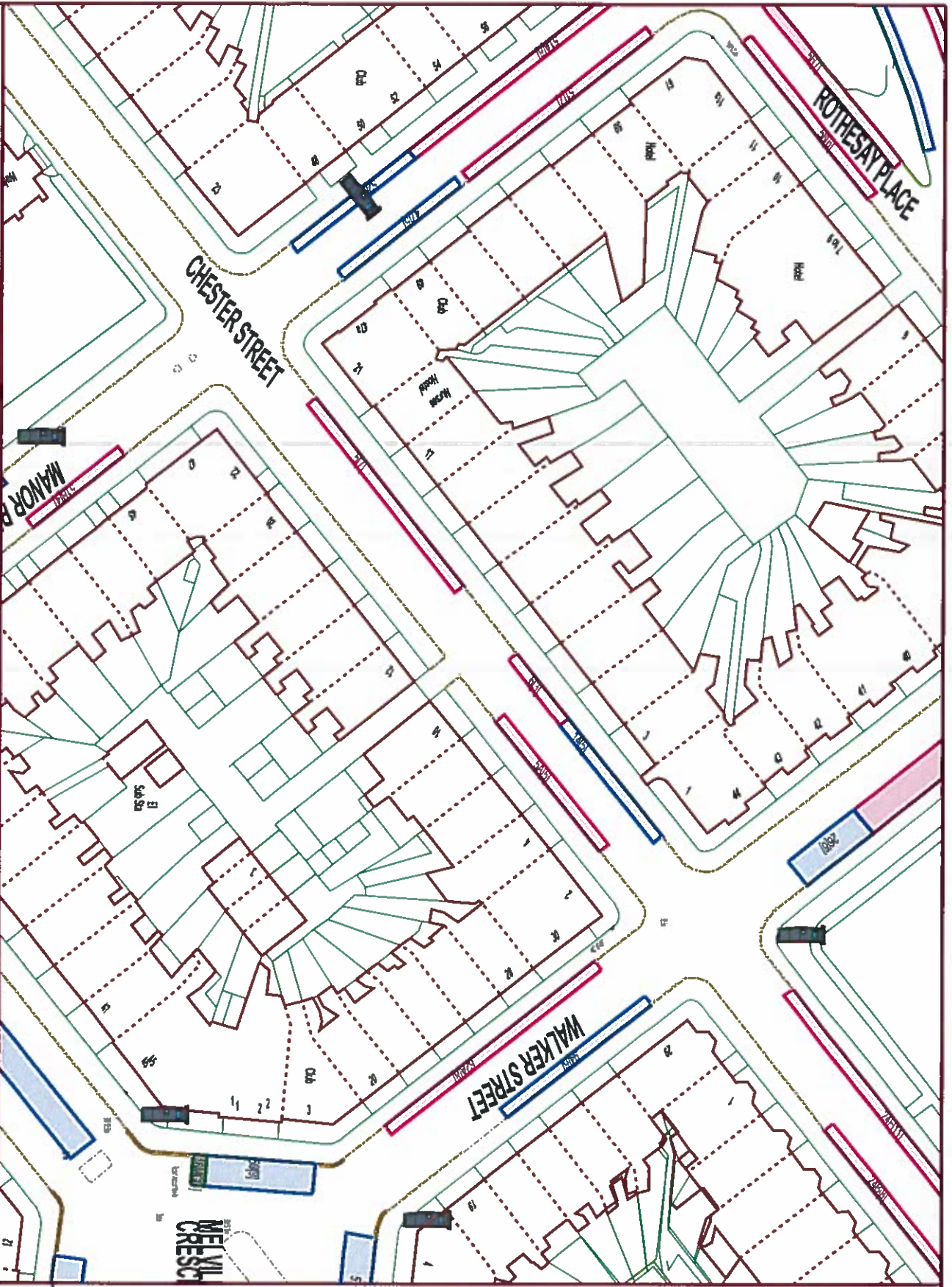

NOTES

REFUSE CONTAINERS ARE NOT NOW TO BE PLACED ON CHESTER STREET PARKING PLACES LOCATIONS TO BE MAINTAINED AS MARKED ON STREET

Produced using Swishworld GIS

Date: 22/09/2014
 Drawn By:
 Dwg No:

1:1000

The material contained in this plot has been reproduced from an Ordnance Survey map with the permission of the Controller of Her Majesty's Stationery Office

**WAITING RESTRICTIONS
 CHESTER STREET**

EDINBURGH
 THE CITY OF EDINBURGH COUNCIL
 Services for Communities,
 4 East Market Street, Edinburgh EH8 8JY
 Tel: 0131 280 2000

NOTES

ONLY ONE RESIDENT PARKING PERMIT
TO BE ISSUED TO NEW DEVELOPMENT
AT 23 CHESTER STREET
48 MANOR PLACE

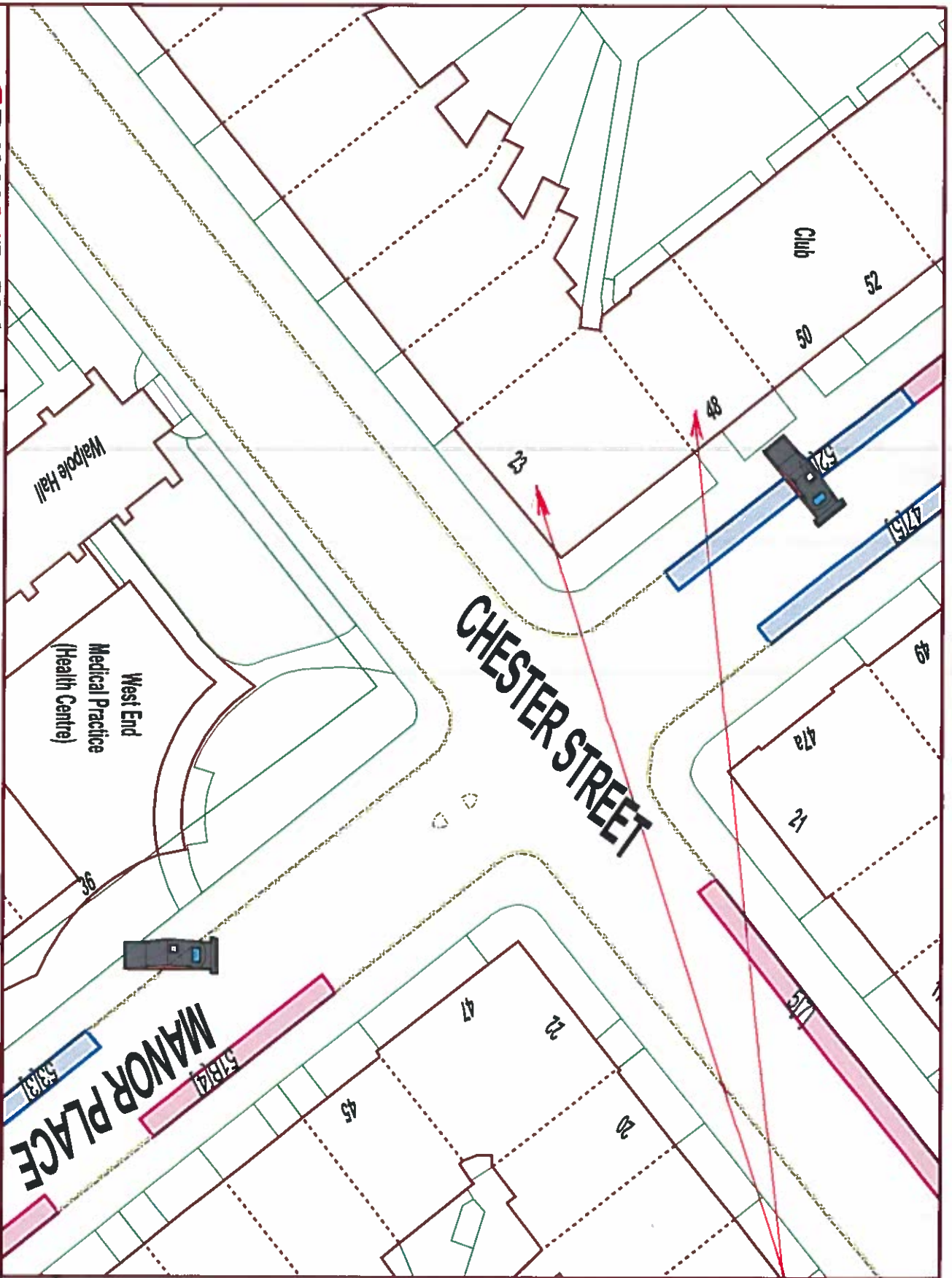

Produced using Scanworld OS

Date: 11/11/2014

Drawn By:

Dwg No.:

1:500

The material contained in this plan has been reproduced from an Ordnance Survey map with the permission of the Controller of HMSO. Crown Copyright.

WAITING RESTRICTIONS

CHESTER STREET & MANOR PLACE

EDINBURGH

THE CITY OF EDINBURGH COUNCIL

Services for Communities,
4 East Market Street, Edinburgh EH8 8DN
Tel: 0131 200 2000

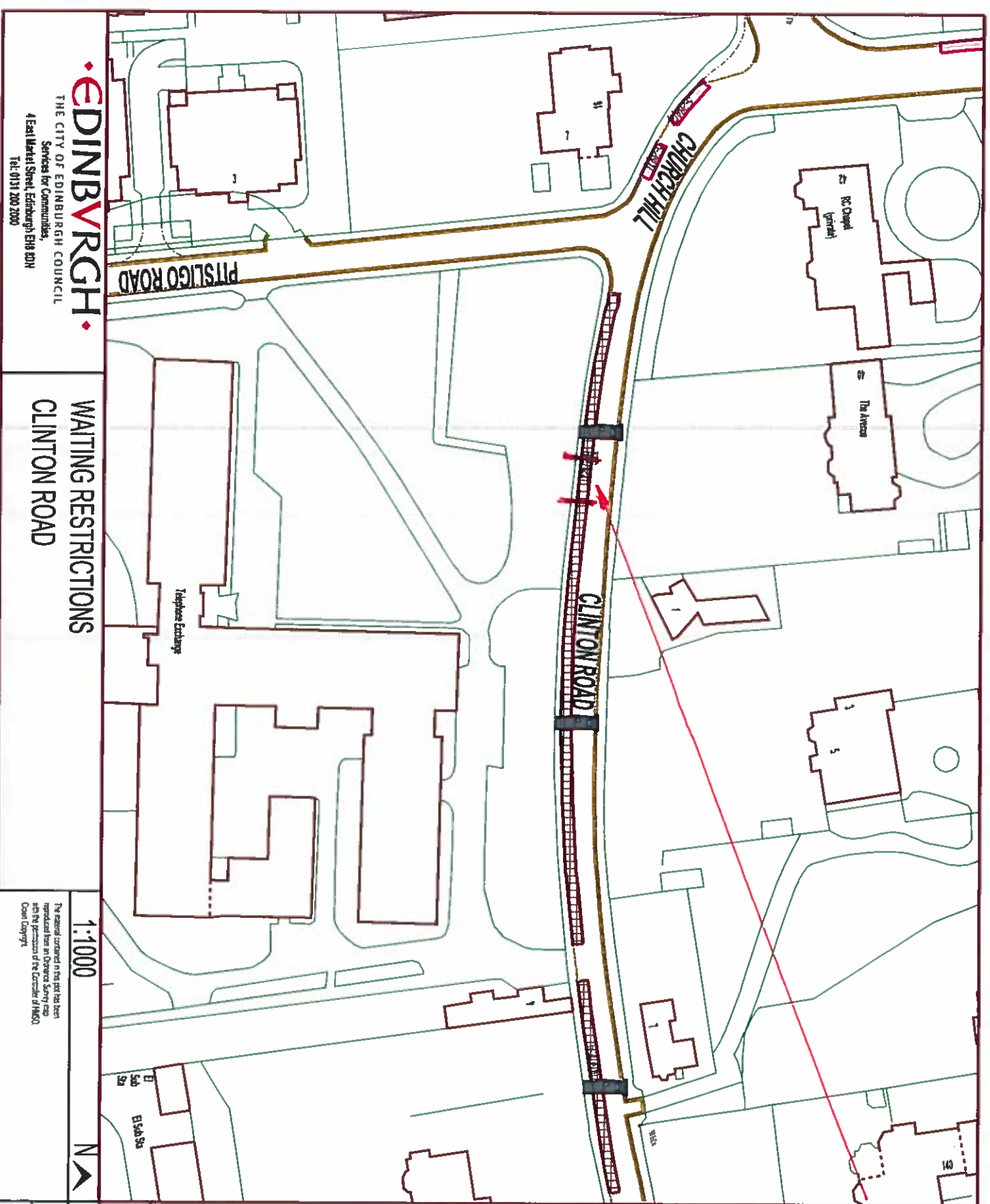

NOTES

REMOVE PART OF SHARED USE
PARKING PLACE TO ALLOW NEW
ACCESS TO BE INTRODUCED

Produced using Smallworld GIS

Date: 11/11/2014

Drawn By:

Dwg No.:

1:1000

The material contained in this plot has been reproduced from an Ordnance Survey map with the permission of the Controller of HMSO, Crown Copyright.

WAITING RESTRICTIONS

CLINTON ROAD

EDINBURGH

THE CITY OF EDINBURGH COUNCIL
Services for Communities,
4 East Market Street, Edinburgh EH8 5DN
Tel: 0131 200 2000

NOTES

ONLY ONE RESIDENT PARKING PERMIT
TO BE ISSUED TO NEW DEVELOPMENT
AT 14 COATES GARDENS

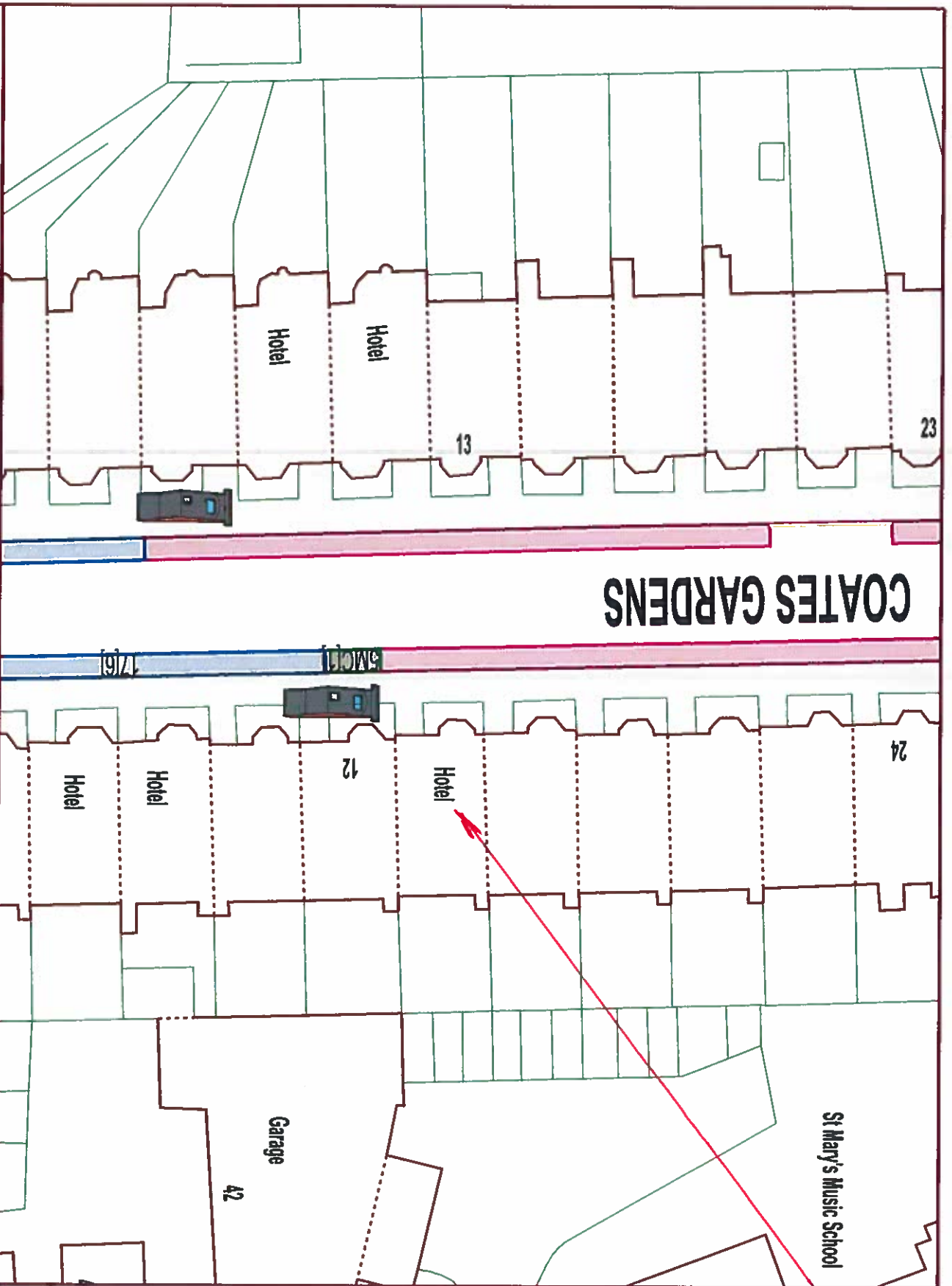

COATES GARDENS

EDINBURGH

THE CITY OF EDINBURGH COUNCIL
Services for Communities,
4 Esai Market Street, Edinburgh EH8 8JN
Tel: 0131 200 2000

WAITING RESTRICTIONS
COATES GARDENS

1:500



The material contained in this plan has been reproduced from an Ordnance Survey map with the permission of the Controller of HMSO, Crown Copyright.



Produced using Smartworld OS

Date: 11/11/2014

Drawn By:

Dwg No.:

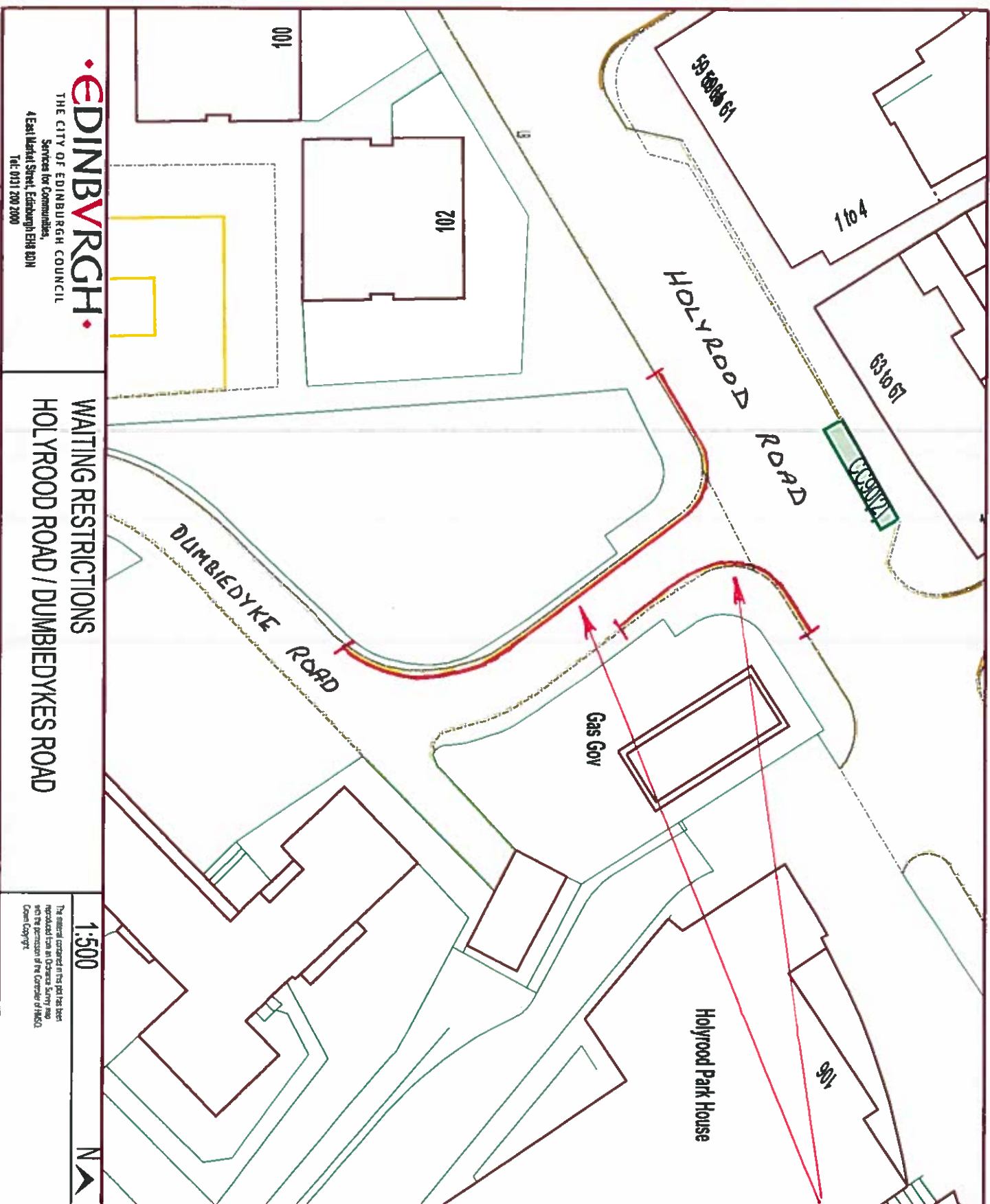

NOTES

INTRODUCE DOUBLE YELLOW
LINE WAITING RESTRICTIONS
AT THE JUNCTION TO MAINTAIN
THE LINE OF SIGHT FOR
PEDESTRIANS AND MOTORISTS

Produced using Snakeworld GIS

Date: 06/10/2014
 Drawn By:
 Dwg No:

1:500
 N
The material contained in this plan has been reproduced from an Ordnance Survey map with the permission of the Controller of Her Majesty's Stationery Office.

WAITING RESTRICTIONS
HOLYROOD ROAD / DUMBIEDYKES ROAD

EDINBURGH
 THE CITY OF EDINBURGH COUNCIL
 Services for Communities,
 4 East Market Street, Edinburgh EH8 8DH
 Tel: 0131 209 2000

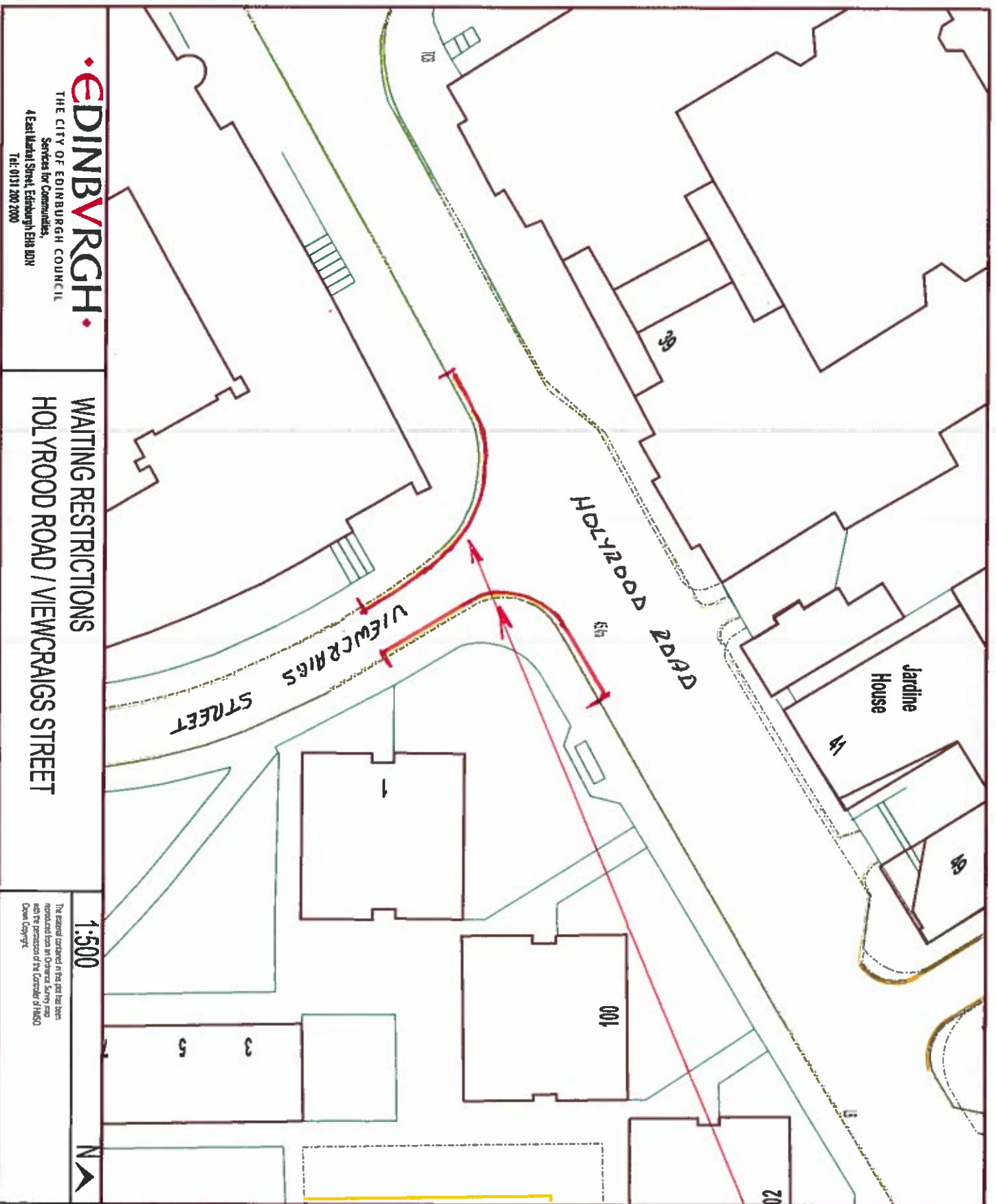

NOTES

INTRODUCE DOUBLE YELLOW
LINE WAITING RESTRICTIONS
AT THE JUNCTION TO MAINTAIN
THE LINE OF SIGHT FOR
PEDESTRIANS AND MOTORISTS

Produced using Smallworld GIS

Date: 06/10/2014
 Drawn By:
 Dwg No:

1:500
 The material contained in this plot has been
 reproduced from an Ordnance Survey map
 and the permission of the Controller of Her
 Majesty's Stationery Office is hereby
 acknowledged.

WAITING RESTRICTIONS
HOLYROOD ROAD / VIEWCRAIGS STREET

EDINBURGH
 THE CITY OF EDINBURGH COUNCIL
 Services for Communities,
 4 East Market Street, Edinburgh EH8 8JH
 Tel: 0131 200 2000

NOTES

NO RESIDENT PARKING PERMITS
TO BE ISSUED TO RESIDENCES
IN NEW DEVELOPMENT
AT 12 HORNE TERRACE

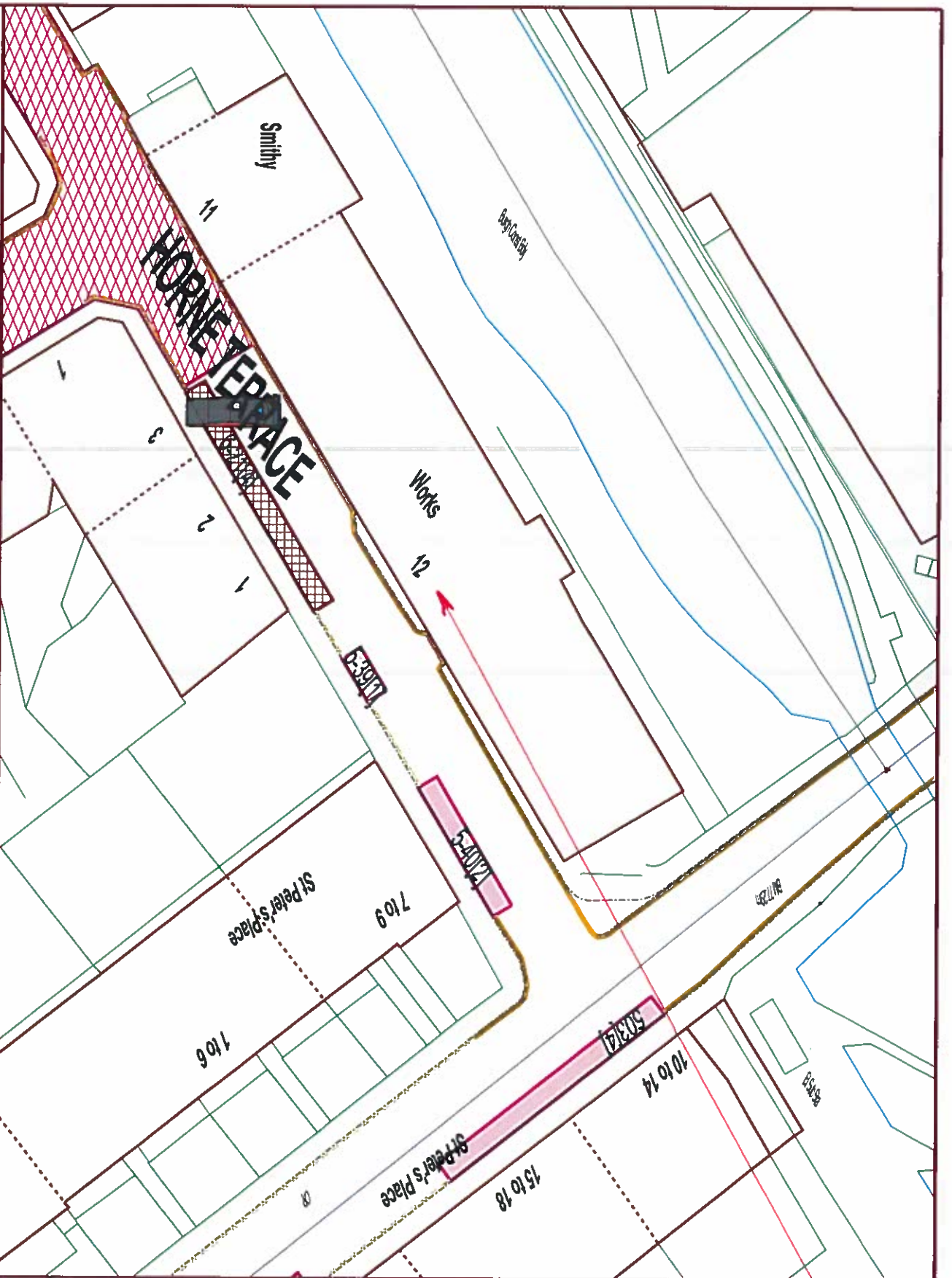

Produced using Smithworld GIS

Date: 11/11/2014

Drawn By:

Dwg No.:

1:500

The material contained in this plot has been reproduced from an Ordnance Survey map with the permission of the Controller of HMSO. Crown Copyright.

**WAITING RESTRICTIONS
HORNE TERRACE**

EDINBURGH
THE CITY OF EDINBURGH COUNCIL
Services for Communities,
4 East Market Street, Edinburgh EH8 8DN
Tel: 0131 200 2000

RILLBANK TERRACE

MILLERFIELD PLACE

459A151 845121 846181 459D121 847141 459B183 459C151 846172

RILLBANK TERRACE

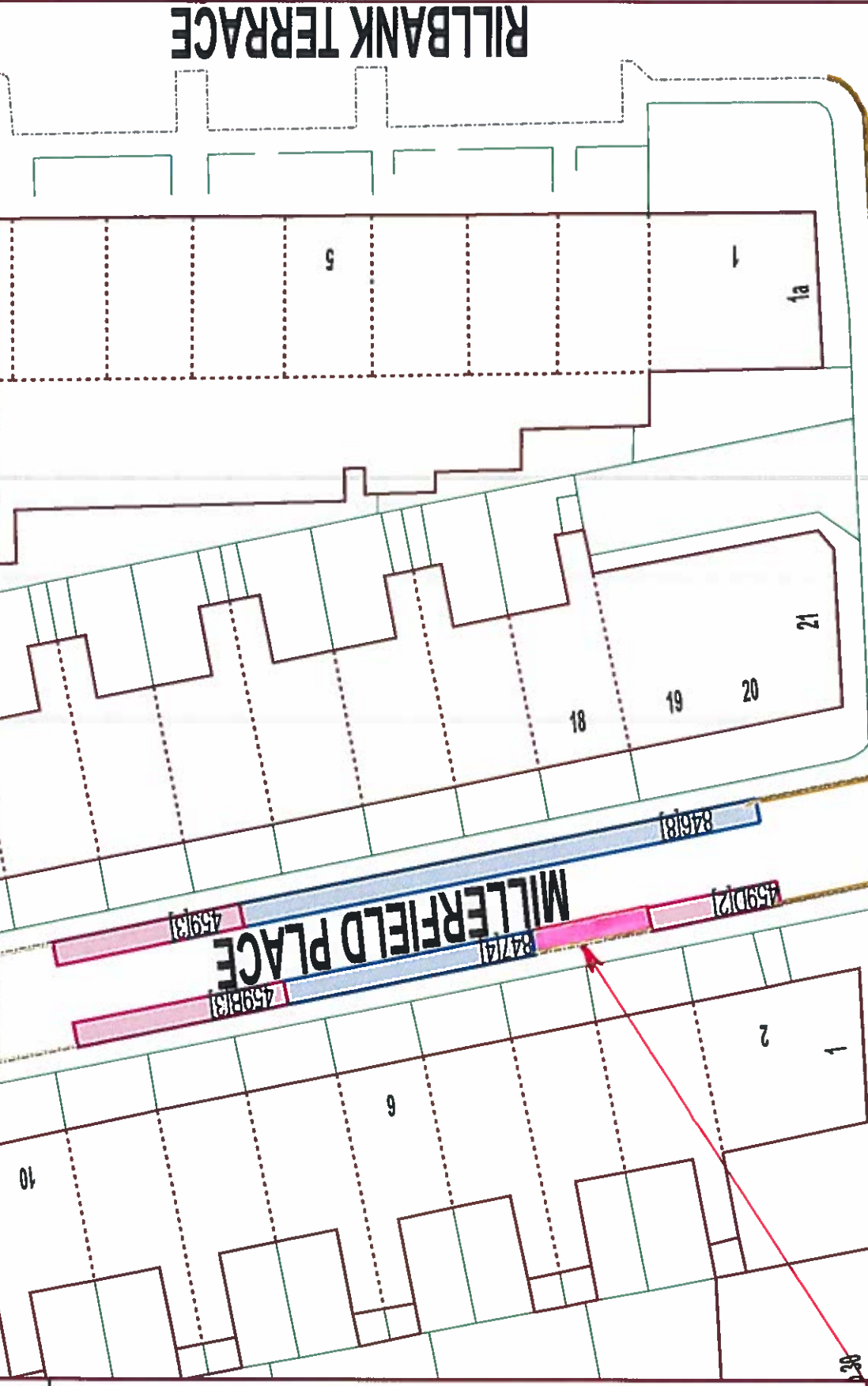

NOTES

REMOVE YELLOW LINE AREA AND REPLACE WITH PERMIT HOLDERS PARKING PLACE

Produced using Southcoast GIS

Date: 22/10/2014

Drawn By:

Dwg No:

1:500



The aerial imagery in the plot has been reclassified from an Ordnance Survey map with the permission of the Controller of MAO. Crown Copyright.

WAITING RESTRICTIONS

MILLERFIELD PLACE

EDINBURGH

THE CITY OF EDINBURGH COUNCIL
Services for Communities,
4 East Market Street, Edinburgh EH9 6UN
Tel: 0131 200 2000

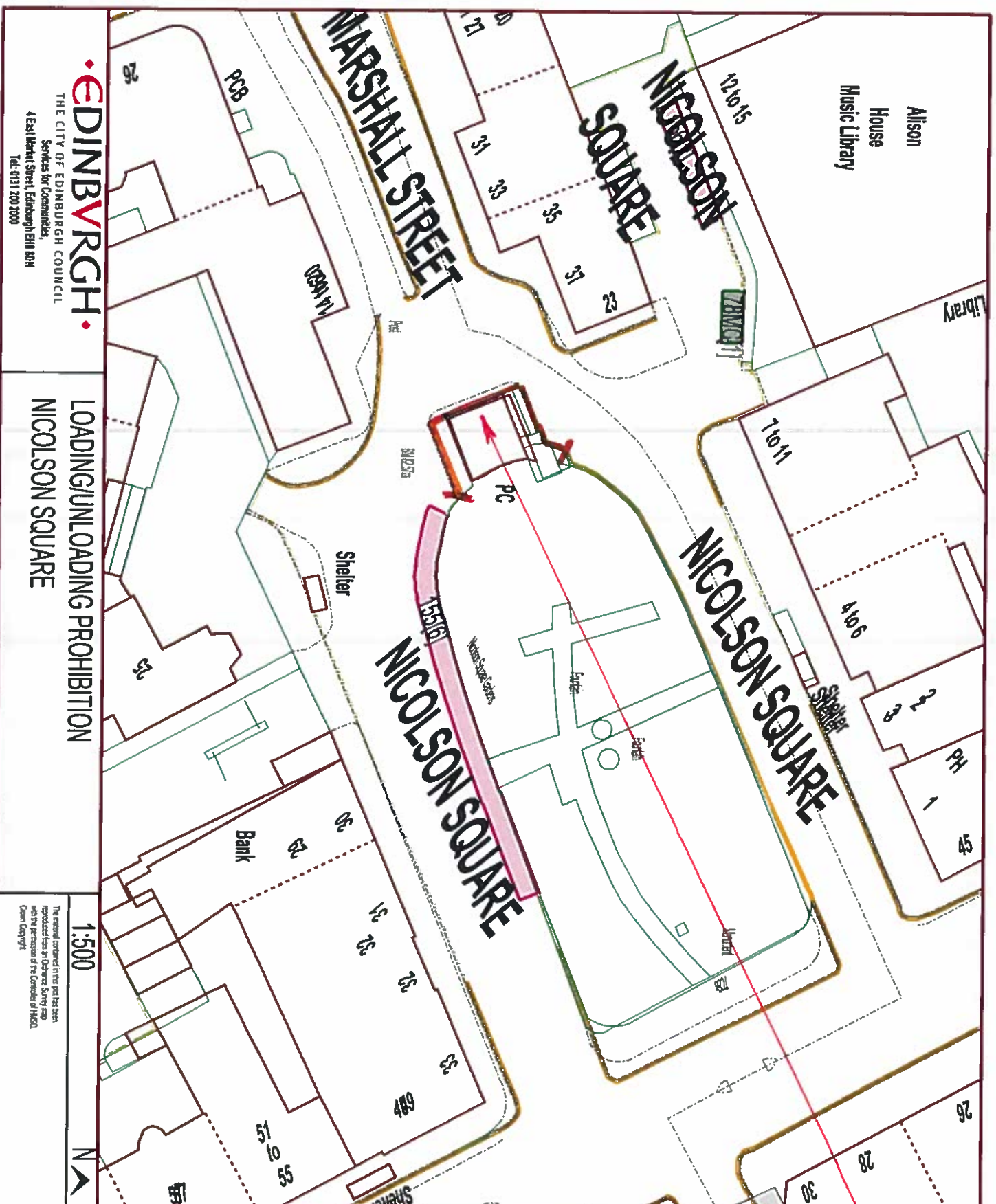

NOTES

ONLY ONE RESIDENT PARKING PERMIT
 TO BE ISSUED TO NEW DEVELOPMENT
 AT 1F1, 1F2, 2F & 3F1 PRINCES
 STREET N°140.

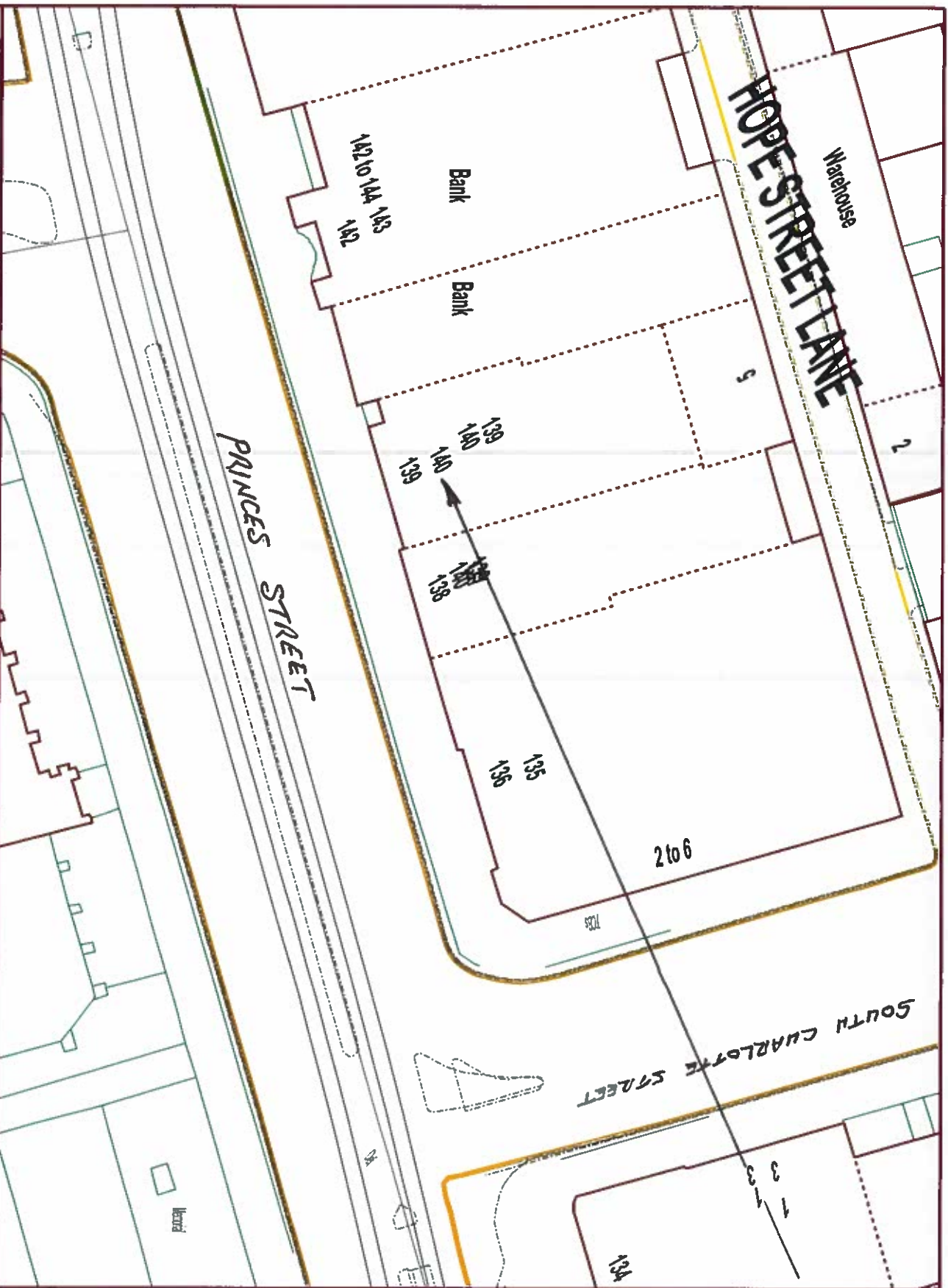

Produced using Surfmorph GS

Date: 11/11/2014
 Drawn By:
 Dwg No:



1:500

The material contained in this plan has been reproduced from an Ordnance Survey map with the permission of the Controller of HMSO Crown Copyright.

WAITING RESTRICTIONS
 PRINCES STREET

EDINBURGH
 THE CITY OF EDINBURGH COUNCIL
 Services for Communities,
 4 East Market Street, Edinburgh EH8 8DN
 Tel: 0131 200 2000

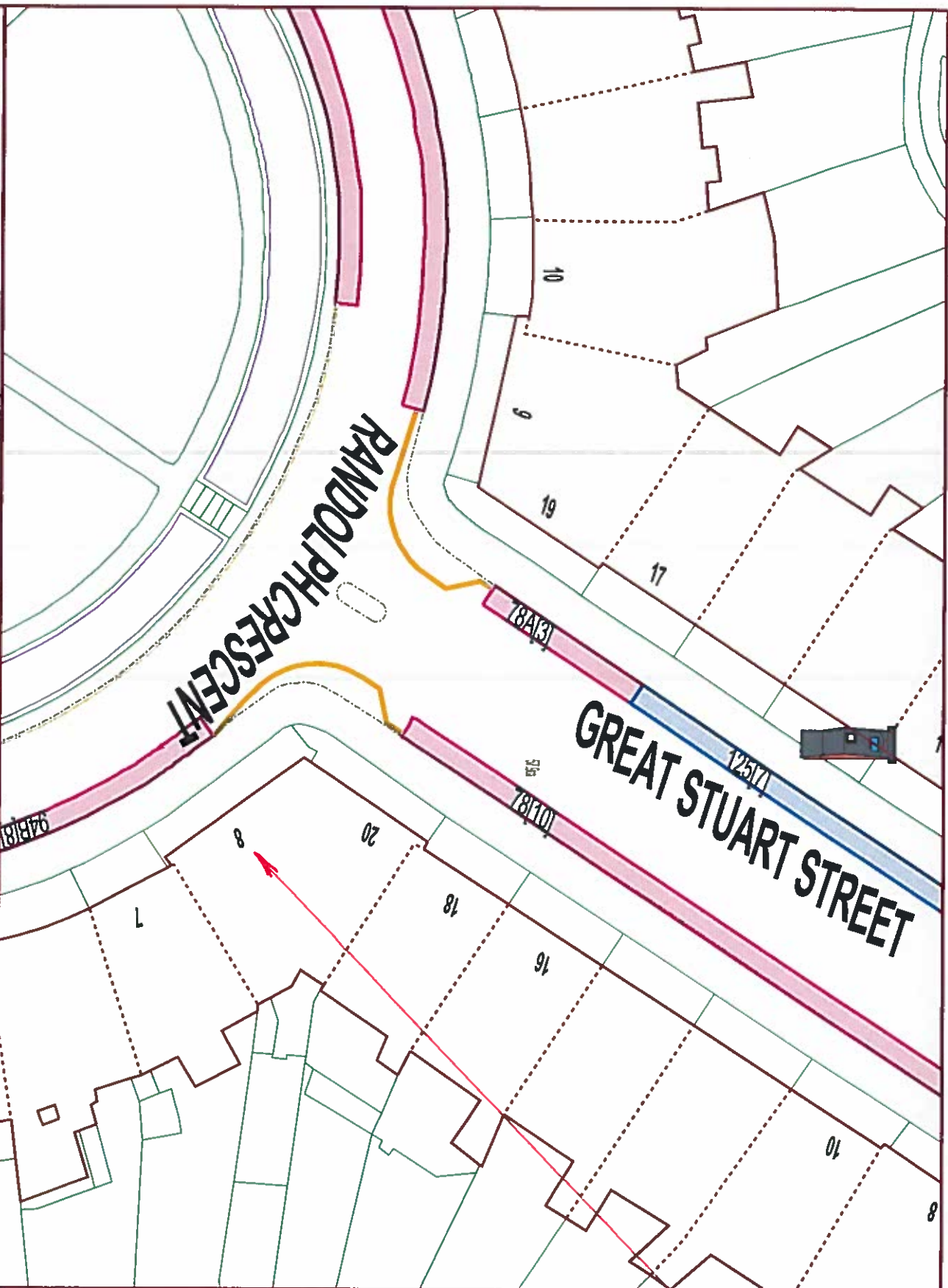

NOTES

ONLY ONE RESIDENT PARKING PERMIT
 TO BE ISSUED TO NEW DEVELOPMENT
 AT 8 RANDOLPH CRESCENT
BASEMENT FLAT ONLY



Produced using Snakehead GIS

Date: 11/11/2014

Drawn By:

Dwg No.:

1:500



The material contained in this plan has been reproduced from an Ordnance Survey map with the permission of the Controller of HMSO. Crown Copyright.

**WAITING RESTRICTIONS
 RANDOLPH CRESCENT**

NOTES

ONLY ONE RESIDENT PARKING PERMIT
TO BE ISSUED TO NEW DEVELOPMENT
AT 6 TORPHICHEN STREET

TORPHICHEN STR

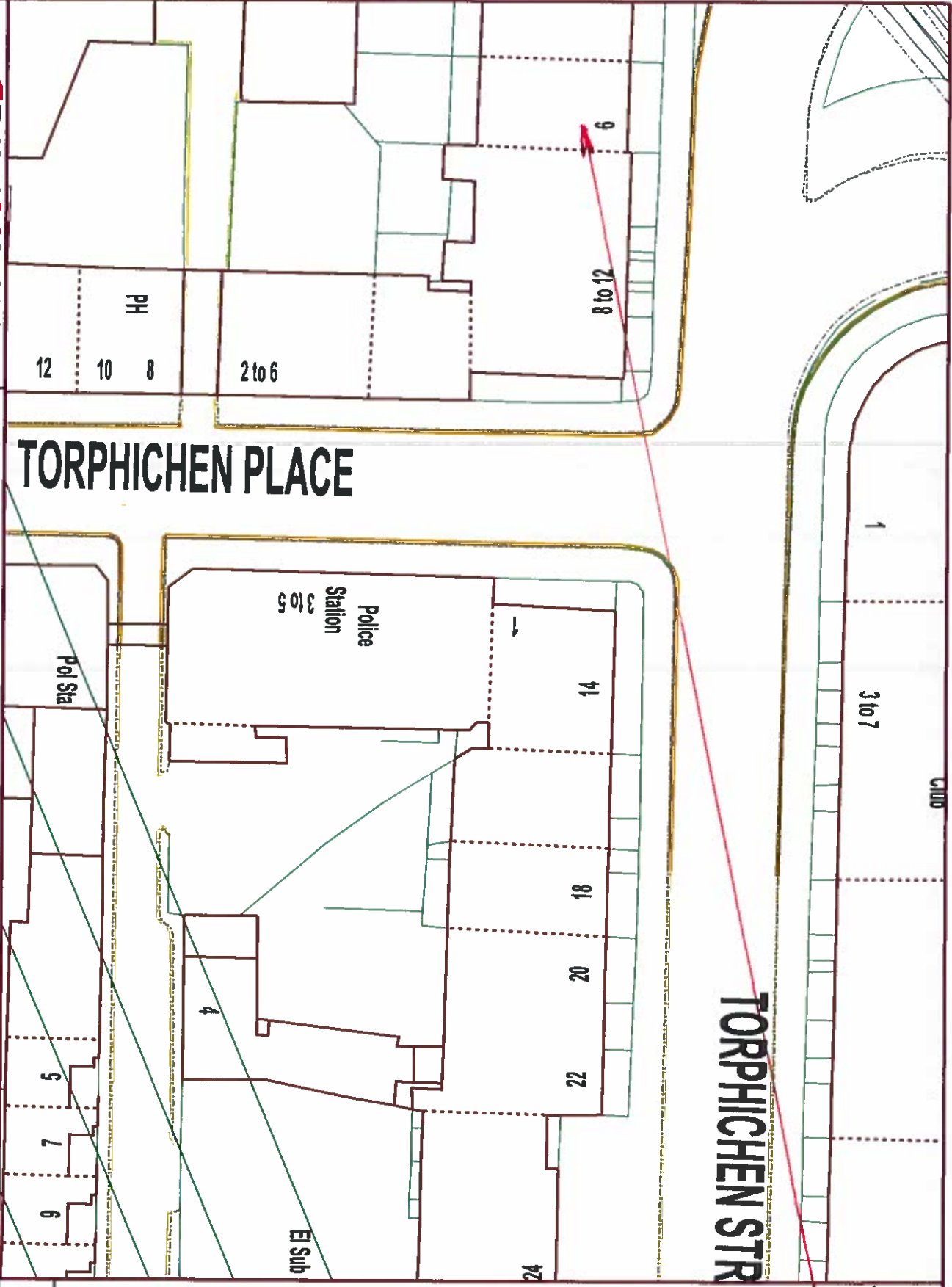

TORPHICHEN PLACE

**WAITING RESTRICTIONS
TORPHICHEN STREET**

1:500



Date: 11/11/2014

Drawn By:

Dwg No.:

Produced using Scanhook! GIS

EDINBURGH

THE CITY OF EDINBURGH COUNCIL

Services for Communities,

4 East Market Street, Edinburgh EH10 2DN

Tel: 0131 200 2000

PH
12 10 8

2 to 6

8 to 12

6

Police
Station
3 to 5

14

18

20

22

24

4

El Sub

Pol Sta

1

3 to 7

CHUR

NOTES

REFUSE CONTAINERS ARE NOT NOW TO BE PLACED ON WALKER STREET PARKING PLACES LOCATIONS TO BE MAINTAINED AS MARKED ON STREET

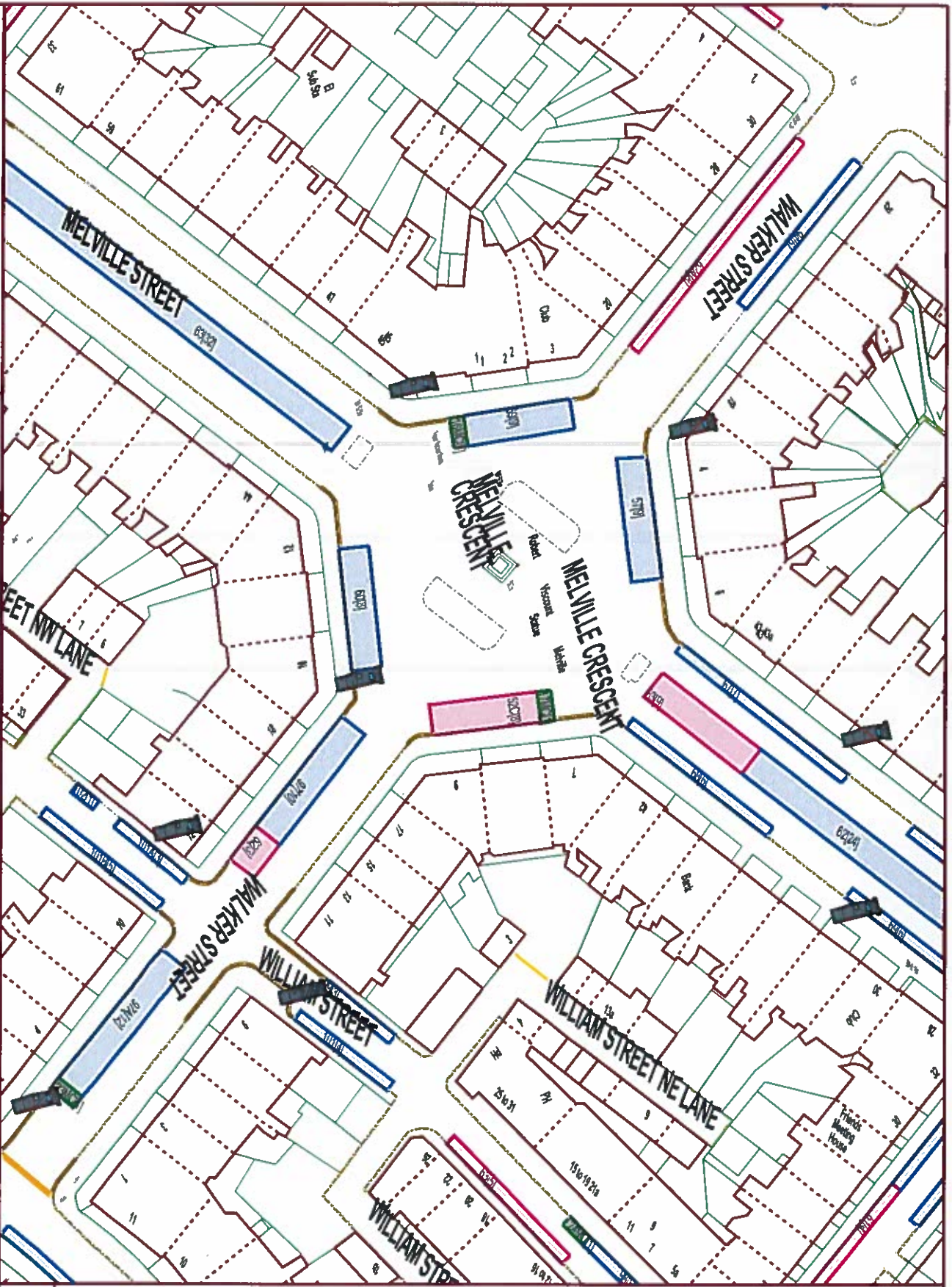

Produced using Smartworld GIS

Date: 22/09/2014

Drawn By:

Dwg No.:

1:1000

The material contained in this plan has been reproduced from an Ordnance Survey map with the permission of the Controller of Her Majesty's Stationery Office.



**WAITING RESTRICTIONS
WALKER STREET**

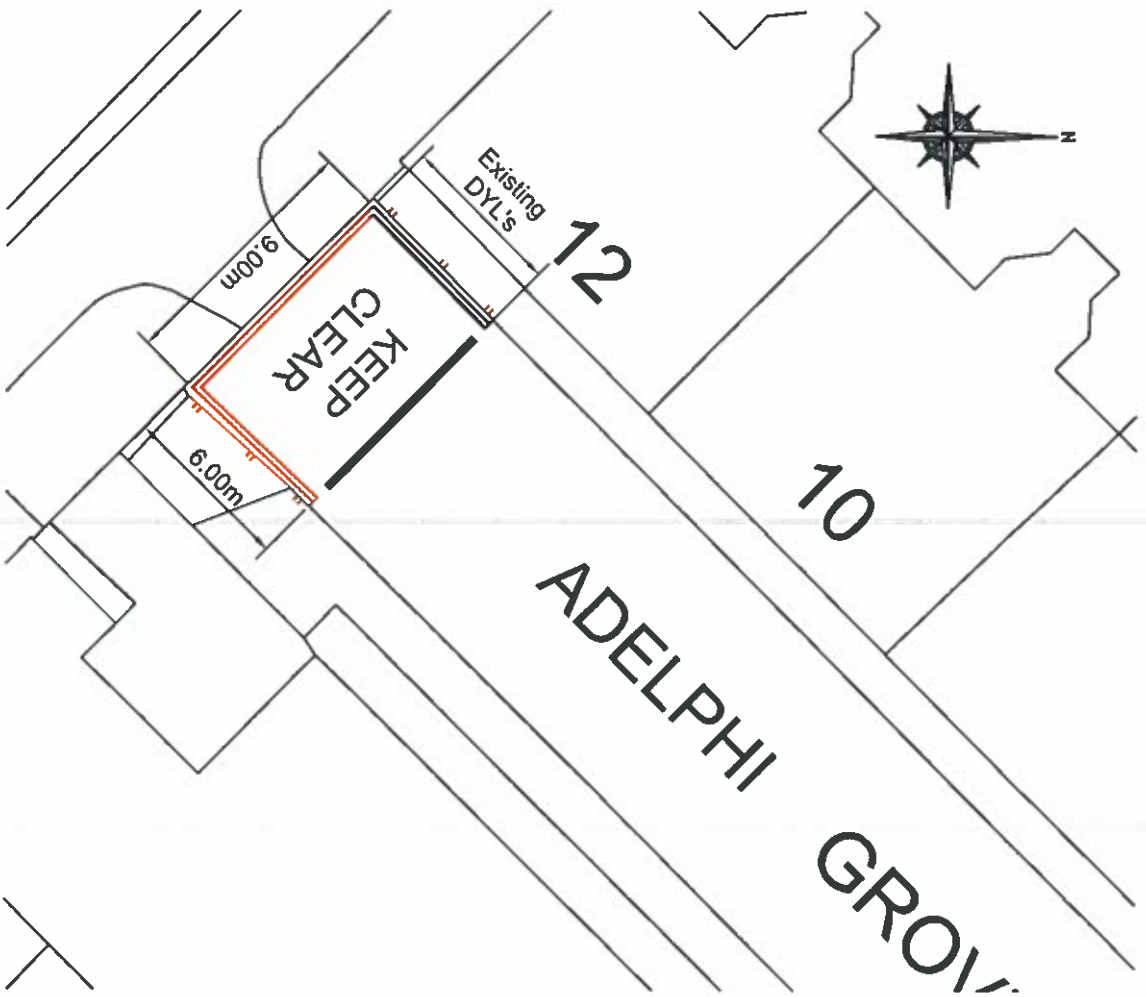

Site Plan

Adelphi Grove : Parking Suspension

Waiting, Loading and unloading of vehicle to be prohibited at any time

Scale 1:2500

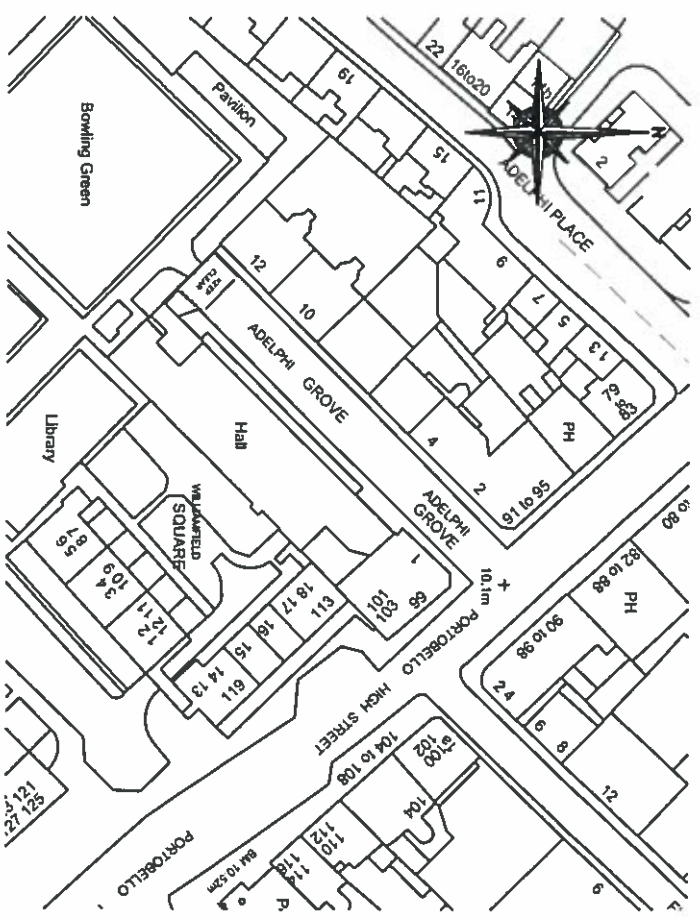

Location Plan

Scale 1:2500

EDINBURGH
THE CITY OF EDINBURGH COUNCIL

The City of Edinburgh Council
East Neighbourhood Office
101 Middle Main Road, Edinburgh
EH16 4ZG Tel. No. 0131 - 529 - 3111

East Neighbourhood
Environment
Team

Adelphi Grove
TRO

Date: Nov 2014	Job No.	Drawn by: KGA
Scale: As Shown		Checked by: AH

Drg No. W17/TRO3/Nov 2014

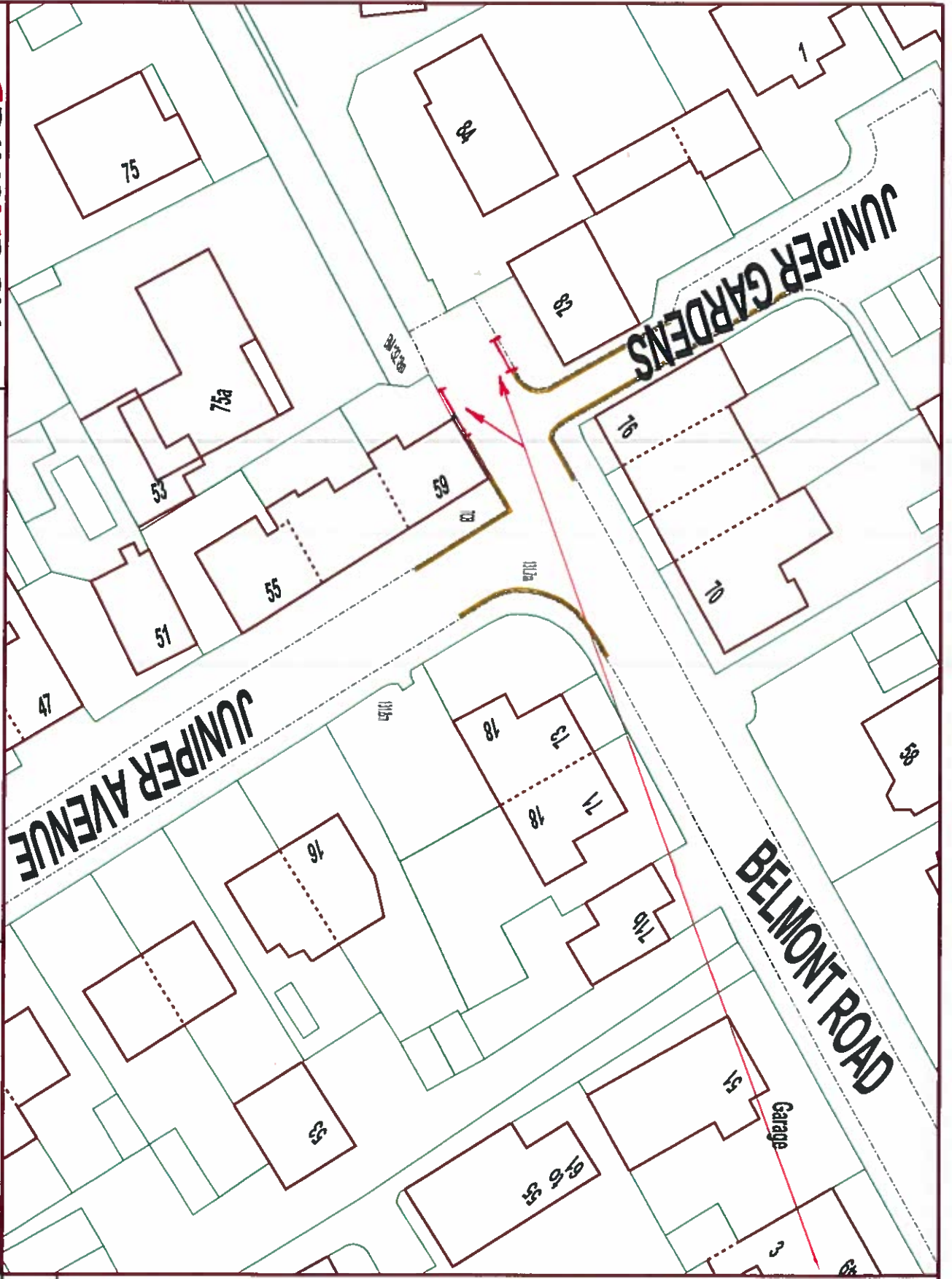

NOTES

EXTEND THE WAITING RESTRICTIONS TO MAINTAIN THE LINE OF SIGHT FOR PEDESTRIANS AND DRIVERS AT THE JUNCTION



Produced using Smartworld GIS

Date: 12/11/2014

Drawn By:

Dwg No.:

1:500

The material contained in this plan has been reproduced from an Ordnance Survey map and the permission of the Controller of Her Majesty's Stationery Office is hereby acknowledged.

**WAITING RESTRICTIONS
BELMONT ROAD**

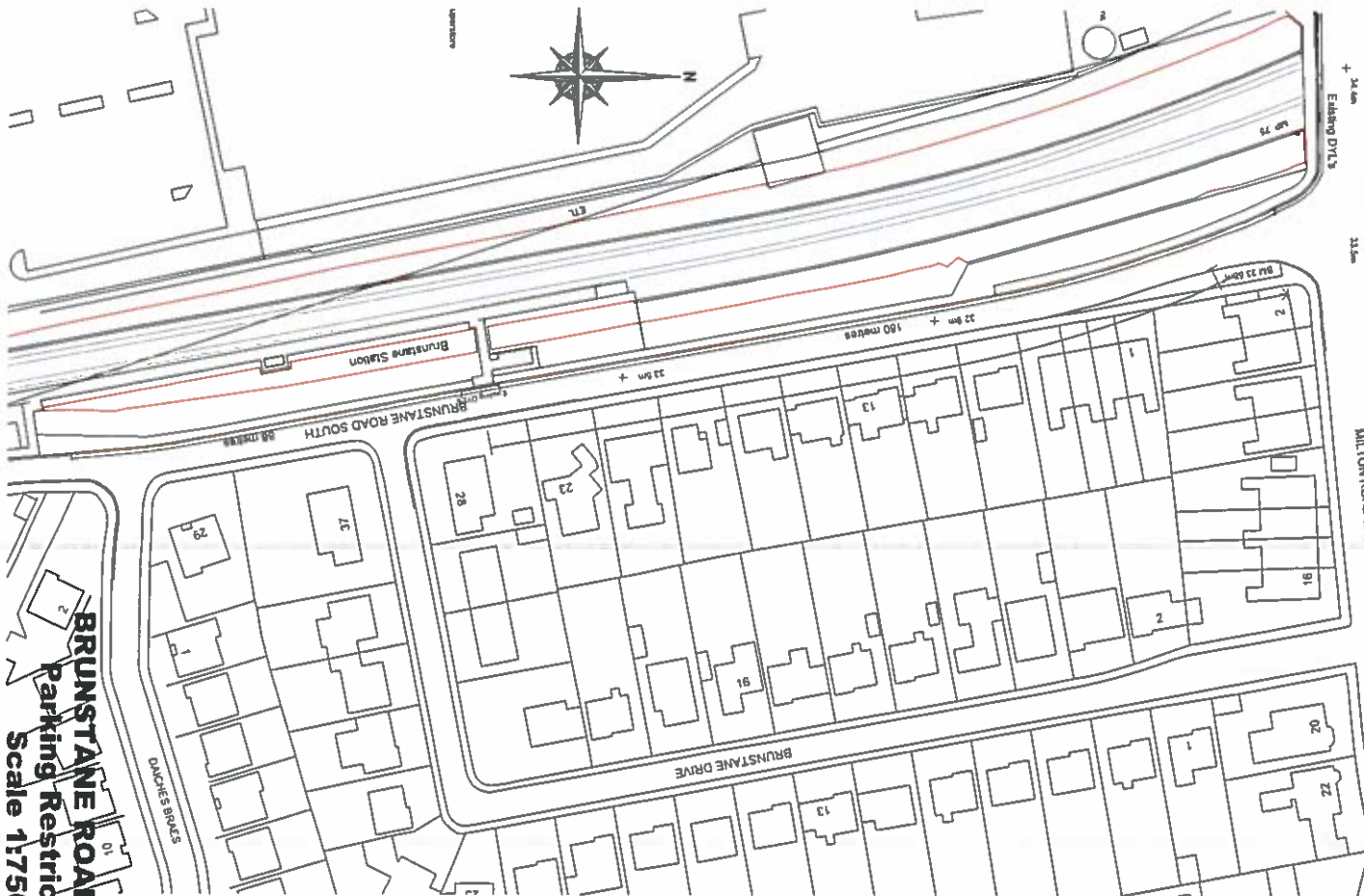

**BRUNSTANE ROAD SOUTH
Parking Restrictions
Scale 1:1750**

: Denotes New TRC
 : Denotes existing Double Yellow Lines

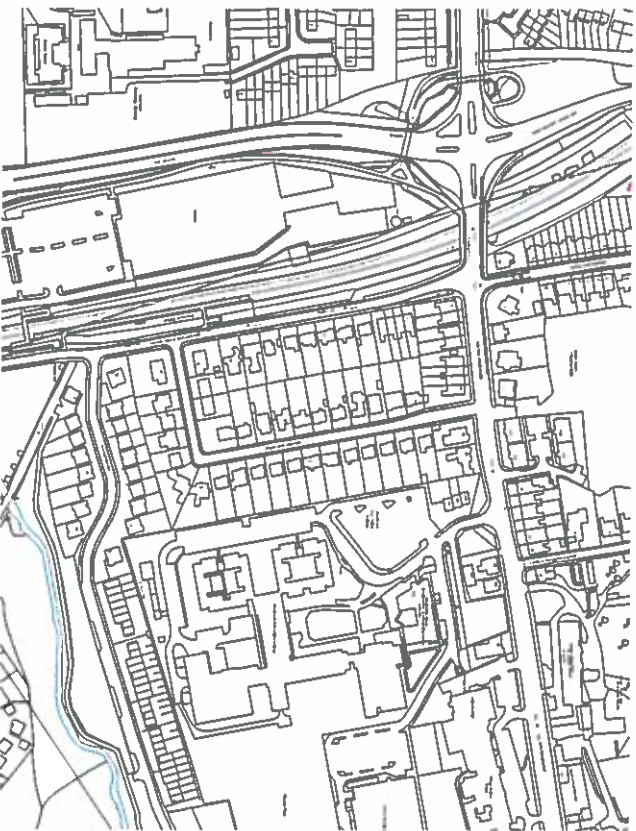

**BRUNSTANE ROAD SOUTH
Location Plan
Scale 1:2500**

 EDINBURGH THE CITY OF EDINBURGH COUNCIL		East Neighbourhood Environment Team
BRUNSTANE ROAD SOUTH PARKING RESTRICTIONS		
Date: August 2014 Scale: As Shown	Mr. Mc...	Drawn By: DGA Checked By: AM
Drg No. W17/002/RM/AUG 2014		

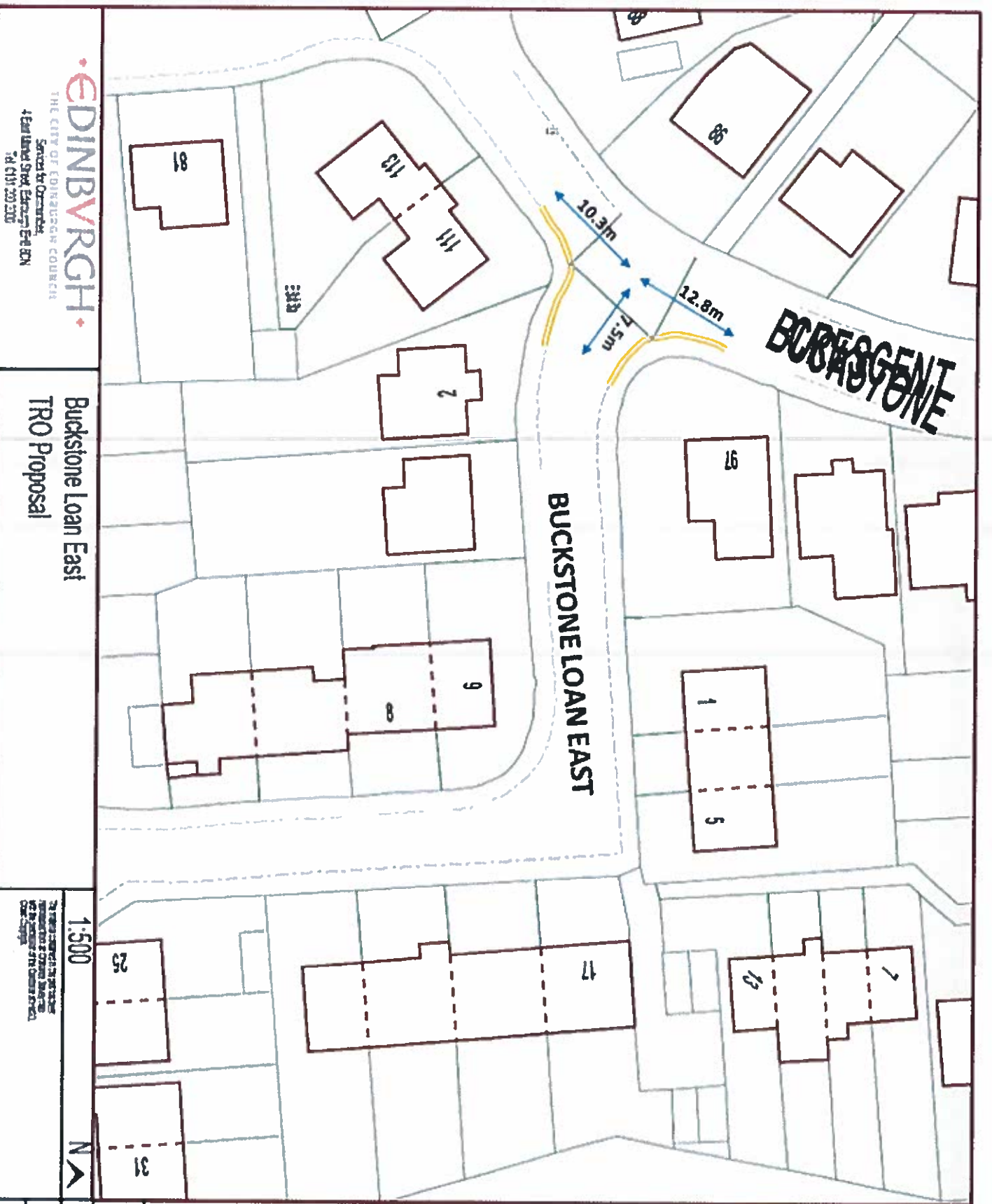

NOTES

Double yellow lines (No waiting at any time) to be installed at the junction of Buckstone Loan East and Buckstone Crescent

Product Long Sealcoat OS

Date: 14/10/2014

Drawn By:

Dwg No:

1:500

The information on this drawing is for reference only. It is not to be used for any other purpose without the written consent of the City of Edinburgh Council.

N

Buckstone Loan East
TRO Proposal

NOTES

REDEFINE THE LENGTH OF
THE PARKING PLACE

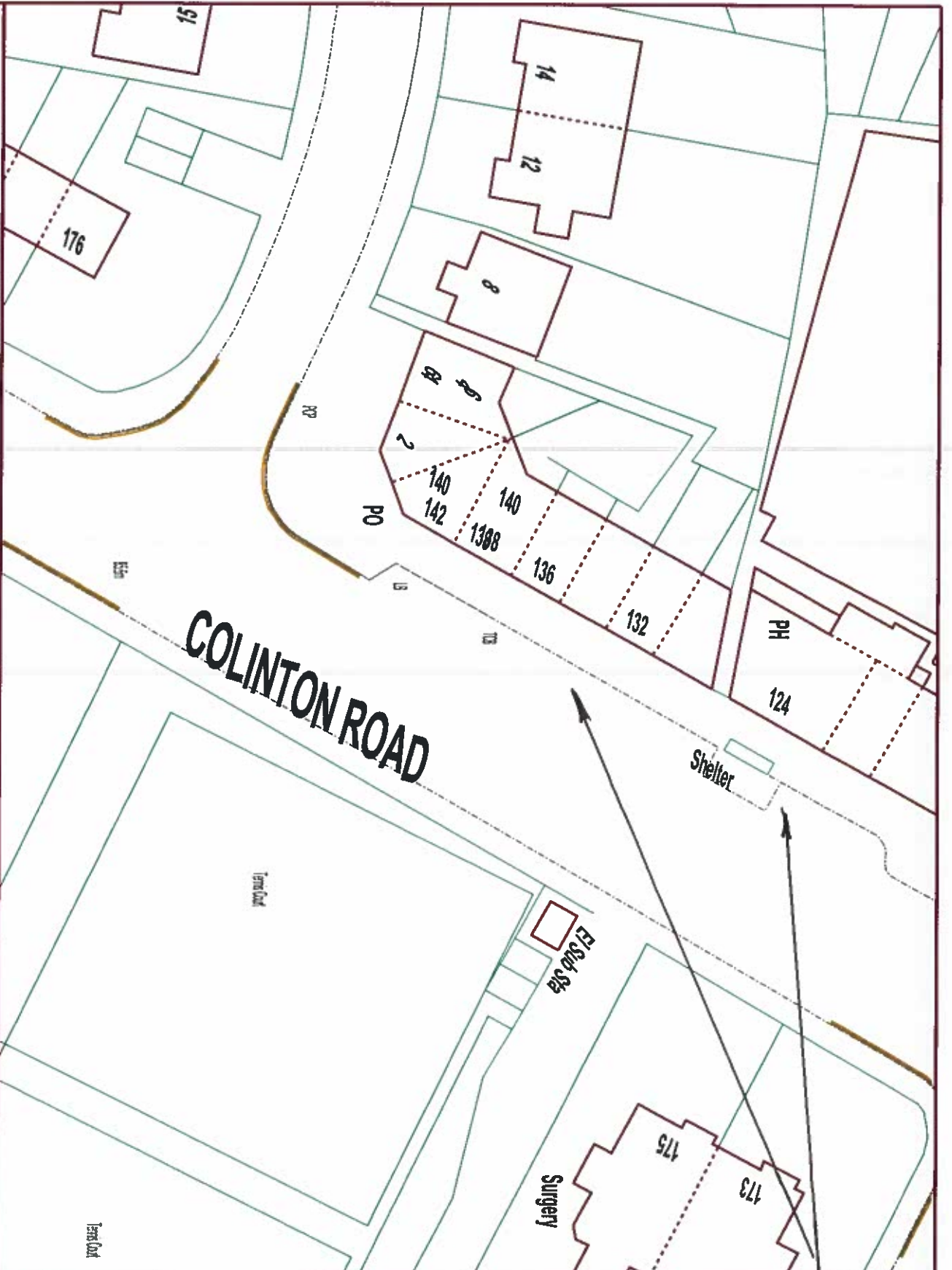

Produced using Snakeworld GIS

Date: 12/11/2014
Drawn By:
Dwg No:

1:500



The material contained in this plan has been reproduced from an Ordnance Survey map with the permission of the Controller of HMSO. Crown Copyright.

WAITING RESTRICTIONS
COLINTON ROAD

EDINBURGH
THE CITY OF EDINBURGH COUNCIL
Services for Communities,
4 East Market Street, Edinburgh EH1 1DN
Tel: 0131 280 2800

**WAITING RESTRICTIONS
 DRUM BRAE DRIVE**

1:500



Date: 11/11/2014
 Drawn By:
 Dwg No:

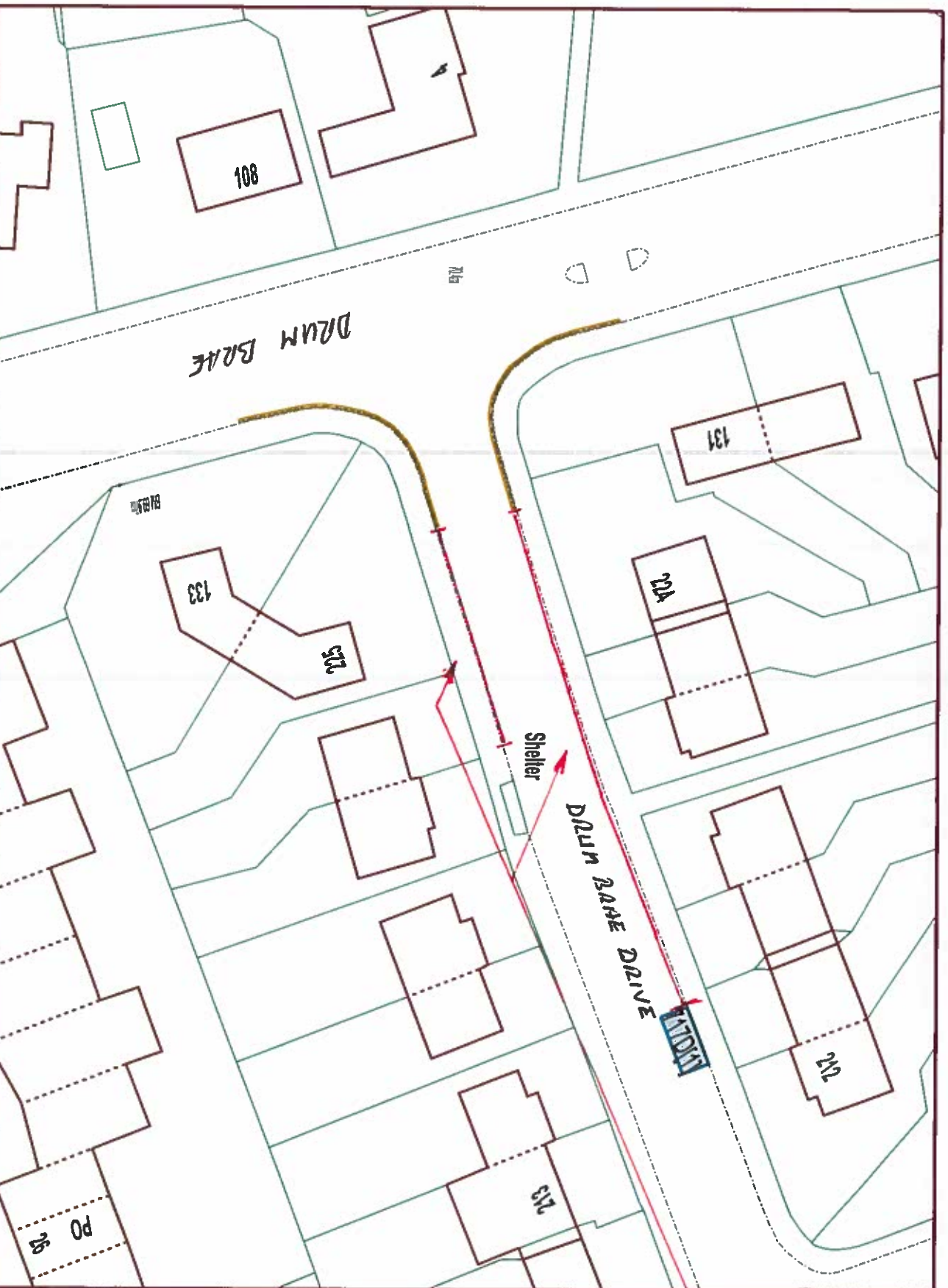

Produced using Scanworld CS3

NOTES

EXTEND DOUBLE YELLOW LINES
 TO MAINTAIN THE LINE OF SIGHT
 BETWEEN DRIVES AND PEDESTANS
 AT THE JUNCTION

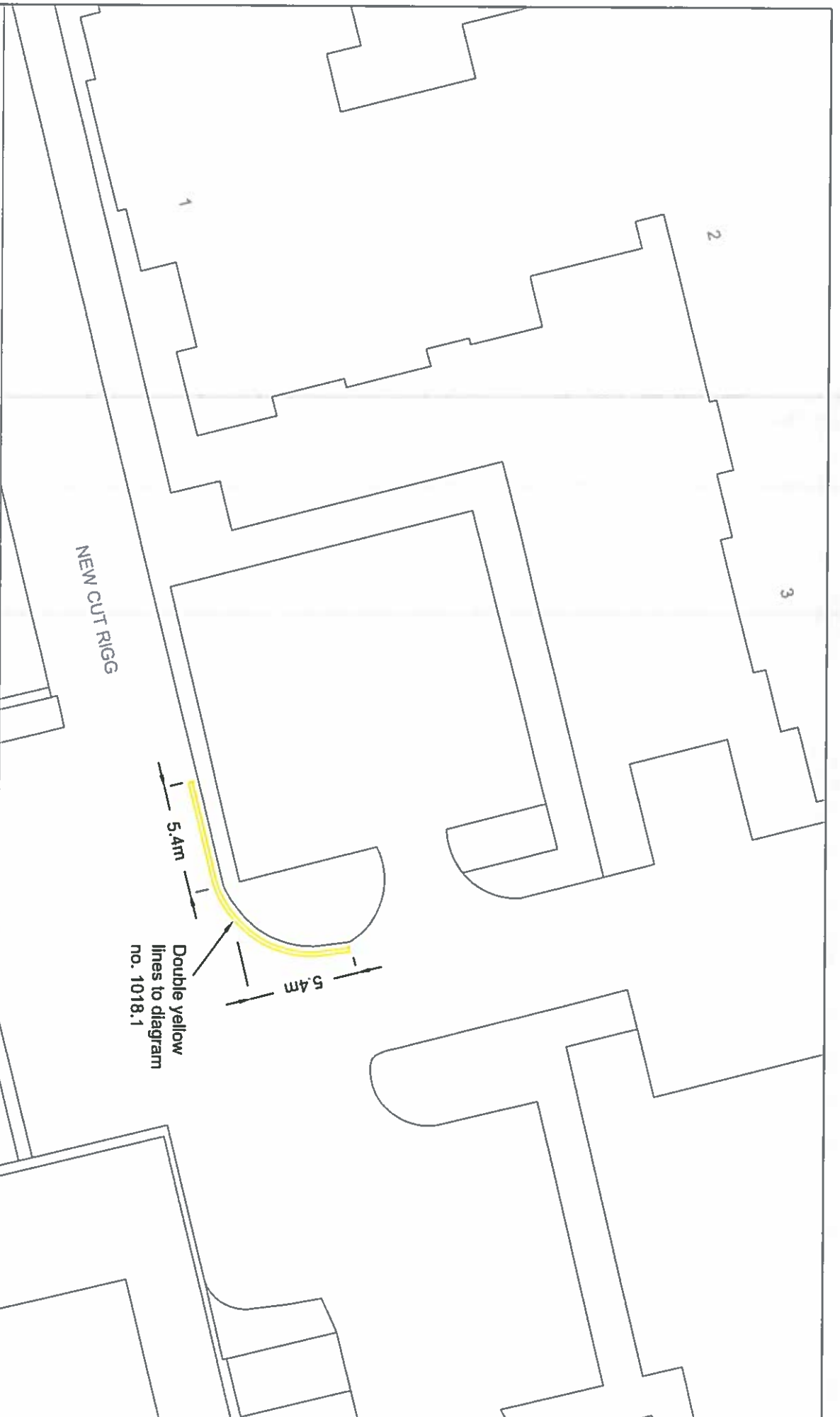

New Cut Rigg Double Yellow Lines

SERVICES FOR COMMUNITIES
 The City of Edinburgh Council
 8 West Pilton Gardens
 Edinburgh EH4 4DP
 Tel. No. 0131 529 5050

SERVICES FOR COMMUNITIES
 NORTH NEIGHBOURHOOD
 ROAD SERVICES

Date:	03/07/2013	Drawn By:	Gavin Rae
Scale:	1:250	Checked By:	Neil MacFarlane
DRG NO. RS/N/New Cut Rigg Double Yellow Lines/GR13			

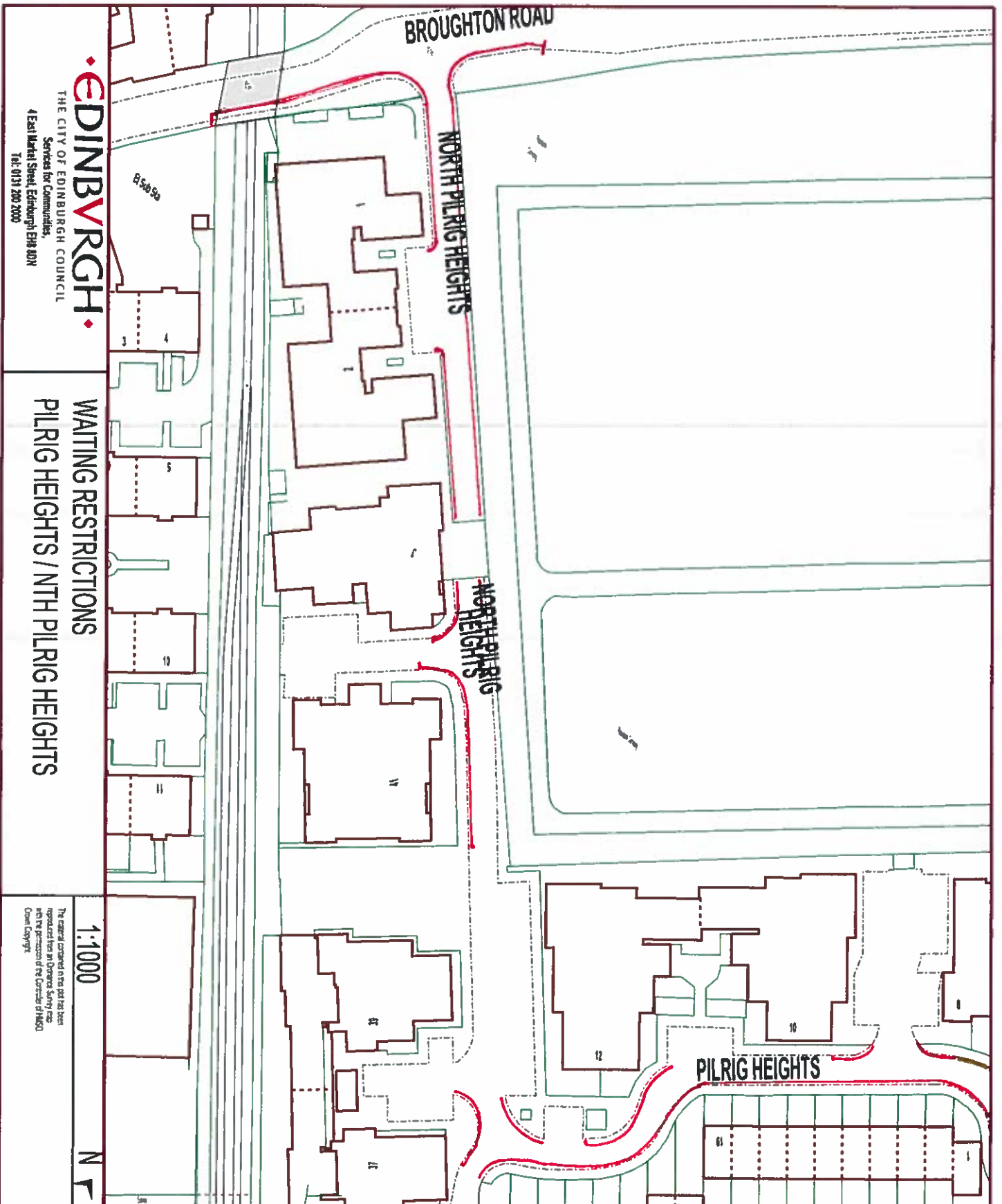

NOTES

- INTRODUCE
- DOUBLE YELLOW LINES
- WAITING RESTRICTIONS

EDINBURGH

THE CITY OF EDINBURGH COUNCIL
 Services for Communities,
 4 East Market Street, Edinburgh EH8 8JN
 Tel: 0131 200 2000

WAITING RESTRICTIONS
PILRIG HEIGHTS / NTH PILRIG HEIGHTS

1:1000



The content contained in this plan has been reproduced from an Ordnance Survey map with the permission of the Controller of Her Majesty's Stationery Office.



Produced using Smalworld GIS

Date: 22/09/2014

Drawn By:

Dwg No:

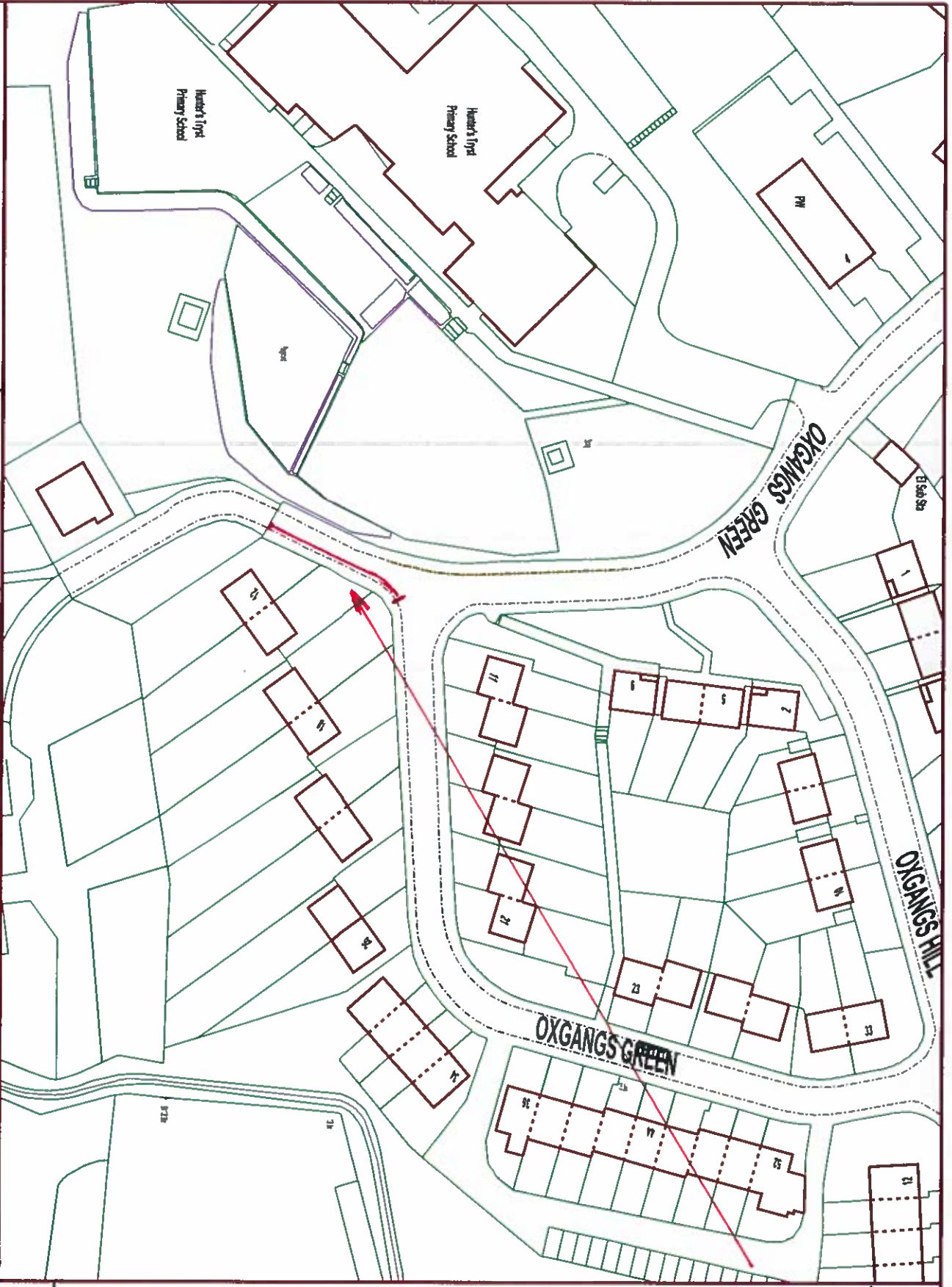

NOTES

INTRODUCE WAITING RESTRICTIONS
 OPERATING 08.00 TO 16.00
 MONDAYS TO FRIDAYS INCLUSIVE
 TO MAINTAIN THE LINE OF SIGHT
 FOR PEDESTRIANS AND DRIVERS
 AT THE JUNCTION



Produced using Smithworld GIS

Date: 12/11/2014

Drawn By:

Dwg No.:

1:1000

The material contained in this plan has been reproduced from an Ordnance Survey map and is the property of the Controller of Her Majesty's Stationery Office.

**WAITING RESTRICTIONS
 OXGANGS GREEN**



Produced using Smalworld GIS

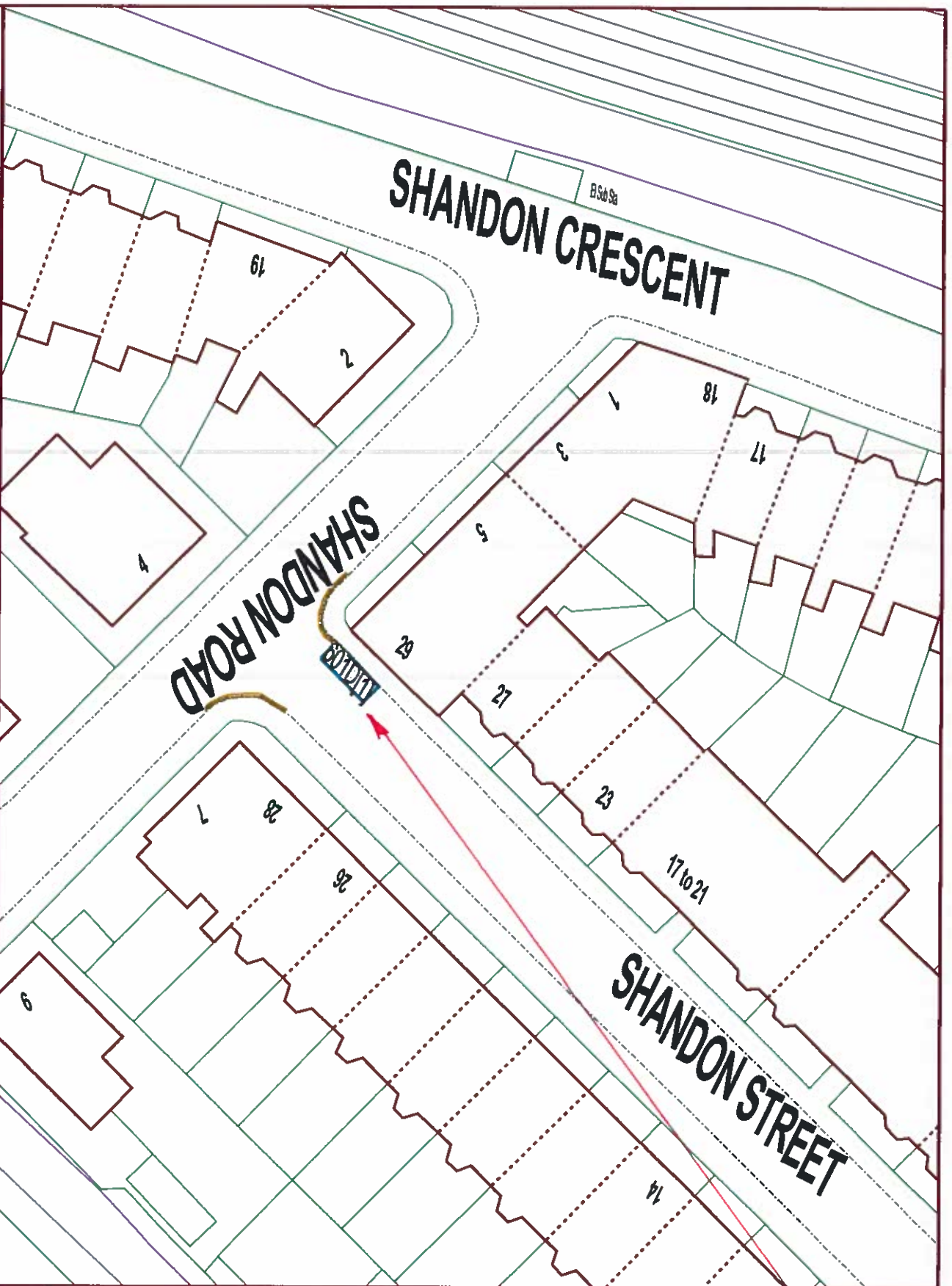

NOTES

ALTER LOCATION OF YELLOW
 LINE TO TAKE ACCOUNT OF
 DISABLED PARKING PLACE

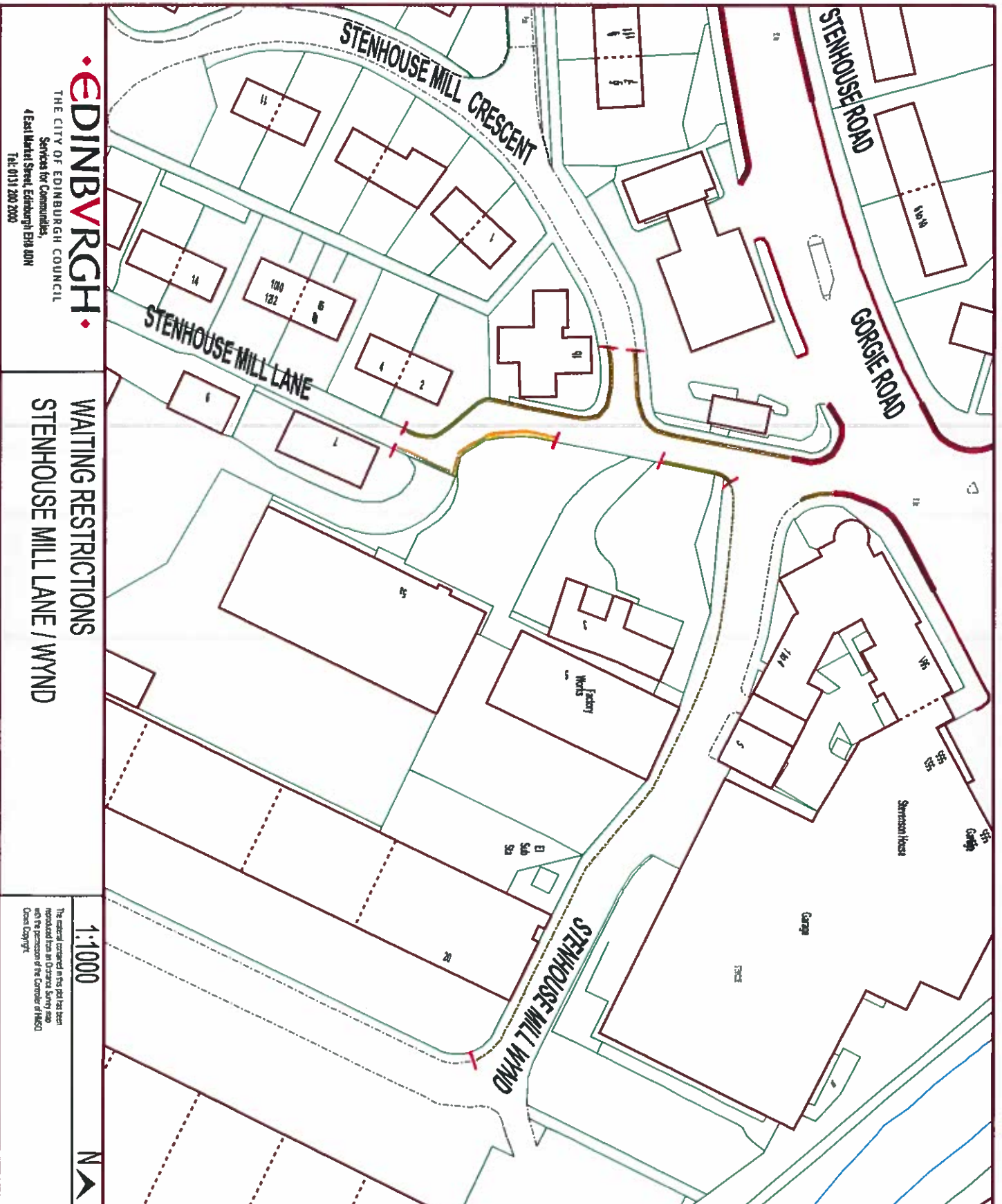

NOTES

AMEND LENGTHS OF
DOUBLE YELLOW LINE
WAITING RESTRICTIONS



Produced using Smallworld GIS

Date: 14/10/2014
 Drawn By:
 Dwg No:

1:1000



The material contained in this plan has been reproduced from an Ordnance Survey map with the permission of the Controller of HMSO. Crown Copyright.

WAITING RESTRICTIONS
STENHOUSE MILL LANE / WYND

EDINBURGH
 THE CITY OF EDINBURGH COUNCIL
 Services for Communities,
 4 East Market Street, Edinburgh EH8 8DN
 Tel: 0131 200 2000

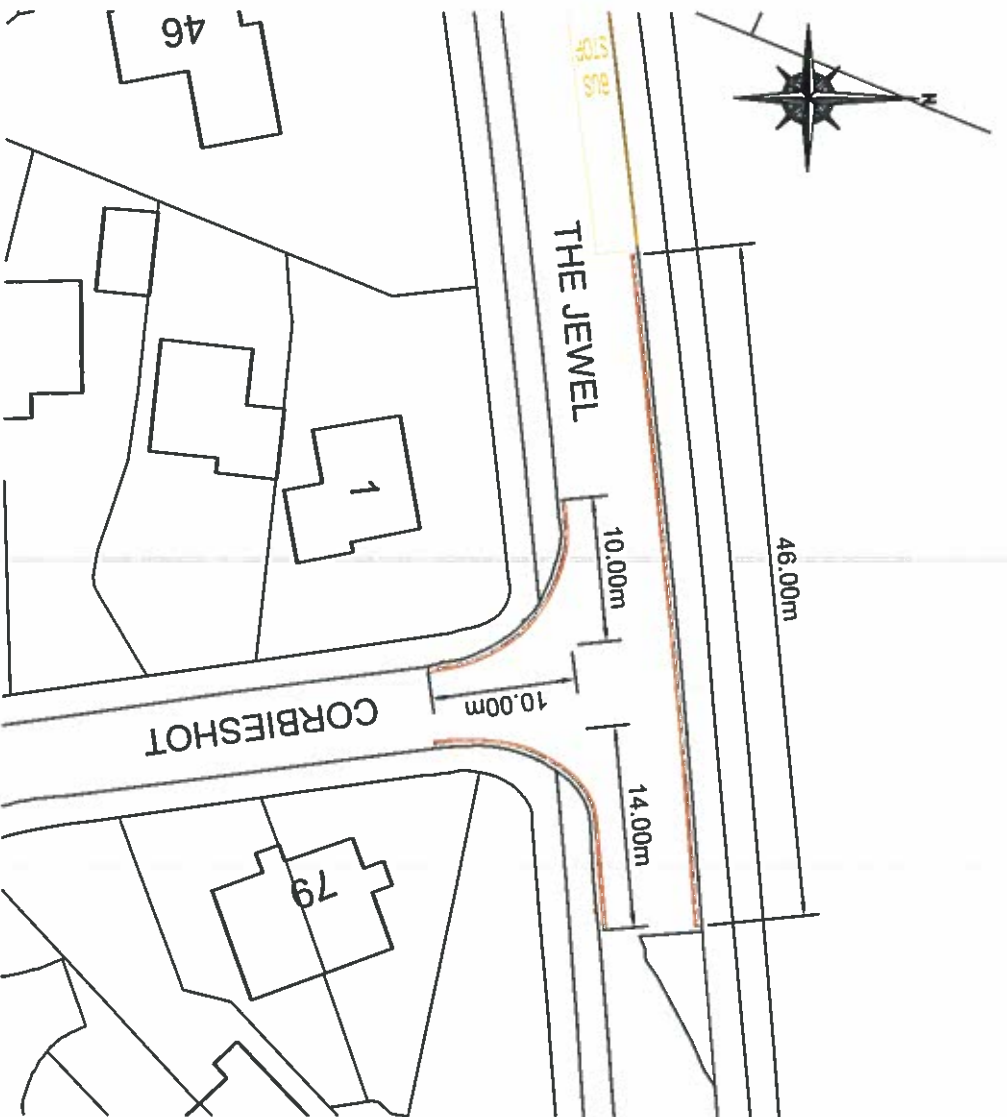

Site Plan

The Jewel : Parking Suspension

Waiting, Loading and unloading of vehicle to be prohibited at any time

Scale 1:500

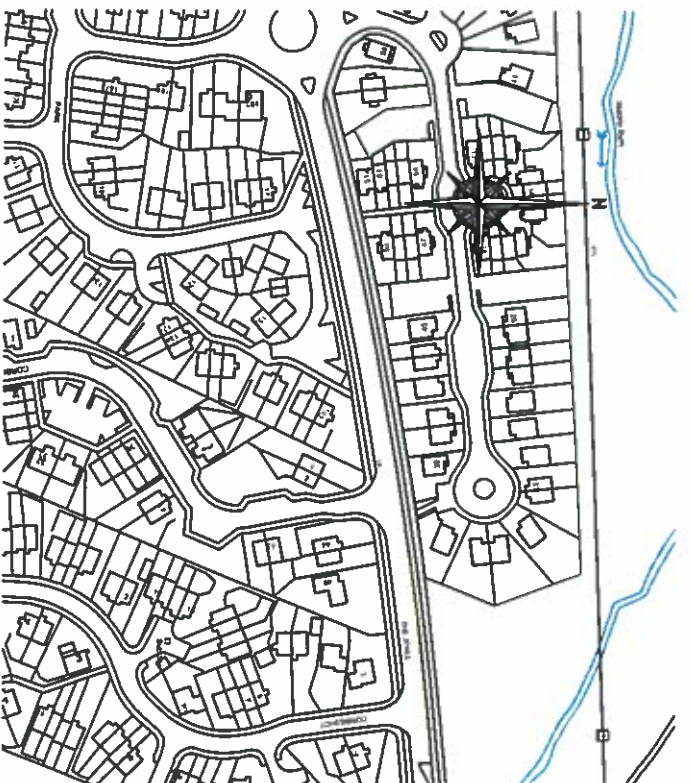

Location Plan

Scale 1:1250

EDINBURGH
THE CITY OF EDINBURGH COUNCIL

The City of Edinburgh Council
East Neighbourhood Office
101 Middle Mains Road, Edinburgh
EH16 4ZG Tel. No. 0131 - 529 - 3111

East Neighbourhood
Environment
Team

THE JEWEL
TRO Parking Suspension

Date: Nov 2014	Job. No.	Drawn by: KDA
Scale: As Shown		Checked by: AH
Drg No. W177/TRO/02/Nov 2014		

NOTES:



<p>EDINBURGH THE CITY OF EDINBURGH COUNCIL</p>		<p>Services for Communities City of Edinburgh 8 West Pilton Gardens Edinburgh EH4 4DP Tel. No 0131 529 5050</p>	<p>Transport Road Services</p>
<p>West Pilton Bank DYLs</p>			
<p>Name: 23/04/2014 Date: 13/05</p>	<p>Job No.</p>	<p>Drawn By: G.D.L. / M.J.</p>	<p>Checked By: G.D.L. / M.J.</p>
<p>DWG. NO. RSN/West Pilton Bank DYL/GR14</p>			